

# Soils Map

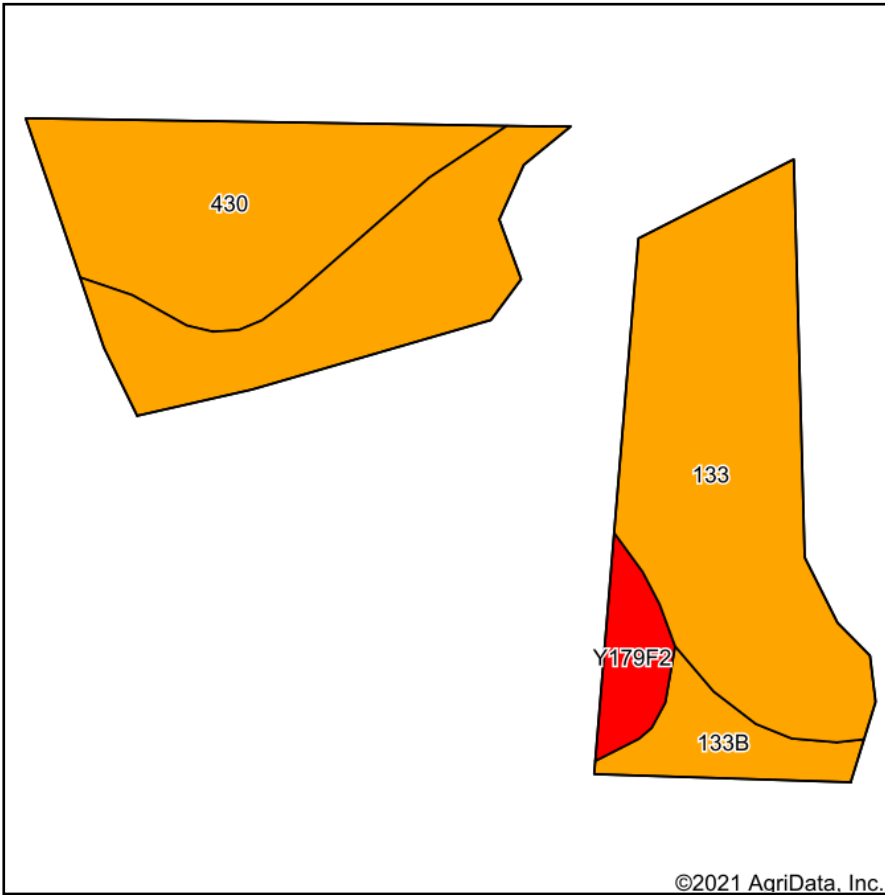

Soils data provided by USDA and NRCS.

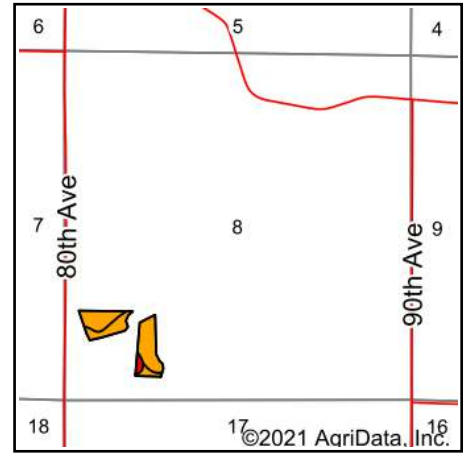

State: **Iowa**  
 County: **Warren**  
 Location: **8-74N-24W**  
 Township: **Squaw**  
 Acres: **12.18**  
 Date: **1/6/2021**



Maps Provided By:



Code	Soil Description	Acres	Percent of field	CSR2 Legend	Non-Irr Class *c	CSR2**	CSR
133	Colo silty clay loam, deep loess, 0 to 2 percent slopes, occasionally flooded	7.45	61.2%		IIw	78	80
430	Ackmore silt loam, 0 to 2 percent slopes, occasionally flooded	3.34	27.4%		IIw	77	83
133B	Colo silty clay loam, dissected till plain, 2 to 5 percent slopes, occasionally flooded	0.81	6.7%		IIw	74	75
Y179F2	Gara loam, dissected till plain, 18 to 25 percent slopes, eroded	0.58	4.8%		VIIe	16	
<b>Weighted Average</b>						<b>74.5</b>	<b>*-</b>

\*\*IA has updated the CSR values for each county to CSR2.

\*- CSR weighted average cannot be calculated on the current soils data, use prior data version for csr values.

\*c: Using Capabilities Class Dominant Condition Aggregation Method

Soils data provided by USDA and NRCS.