

Soils Map

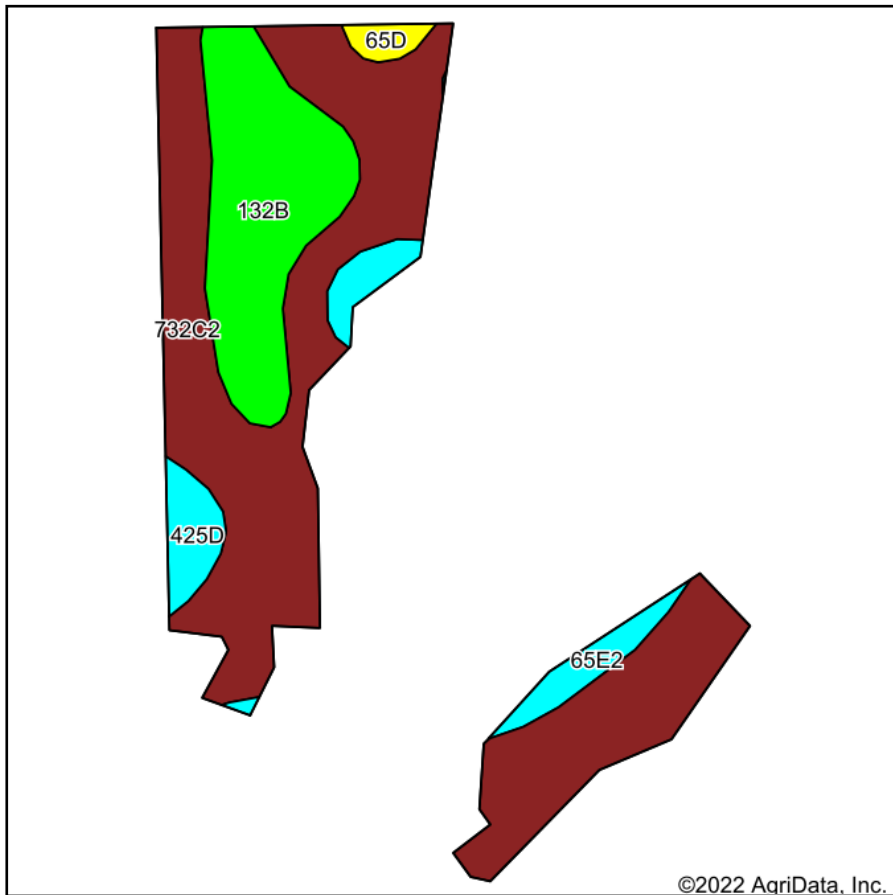

Soils data provided by USDA and NRCS.

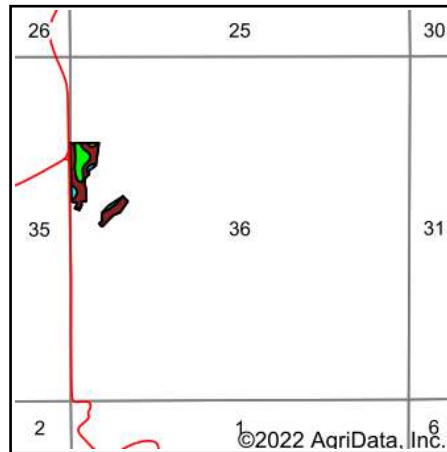

State: **Iowa**
 County: **Monroe**
 Location: **36-72N-18W**
 Township: **Guilford**
 Acres: **8.45**
 Date: **9/30/2022**

Hawkeye Farm Mgmt & Real Estate

United Country Real Estate
 22 N Main, Alto IA Phone: 515-952-7796
 Email: hawkeye@ucia.com
 Office: 515-265-1000
 www.iowawhitehillfarms.com

Maps Provided By:

surety
 CUSTOMIZED ONLINE MAPPING
 © AgriData, Inc. 2021 www.AgriDataInc.com



Area Symbol: IA135, Soil Area Version: 29

Code	Soil Description	Acres	Percent of field	CSR2 Legend	Non-Irr Class *c	CSR2**	CSR	*n NCCPI Soybeans	
732C2	Weller silty clay loam, 5 to 9 percent slopes, moderately eroded	5.54	65.6%		Ille	59	40	71	
132B	Weller silt loam, 2 to 5 percent slopes	1.93	22.8%		Ille	67	60	84	
65E2	Lindley loam, 14 to 18 percent slopes, moderately eroded	0.52	6.2%		Vle	29	28	55	
425D	Keswick loam, 9 to 14 percent slopes	0.33	3.9%		IVe	8	16	45	
65D	Lindley loam, 9 to 14 percent slopes	0.13	1.5%		IVe	43	40	66	
Weighted Average						3.24	56.7	42.9	*n 71.9

**IA has updated the CSR values for each county to CSR2.

*n: The aggregation method is "Weighted Average using all components"

*c: Using Capabilities Class Dominant Condition Aggregation Method

Soils data provided by USDA and NRCS.