

# Soils Map

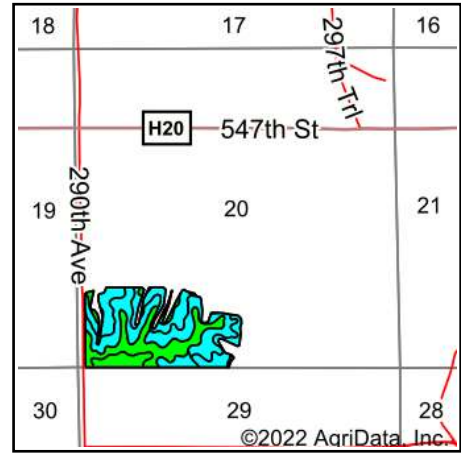
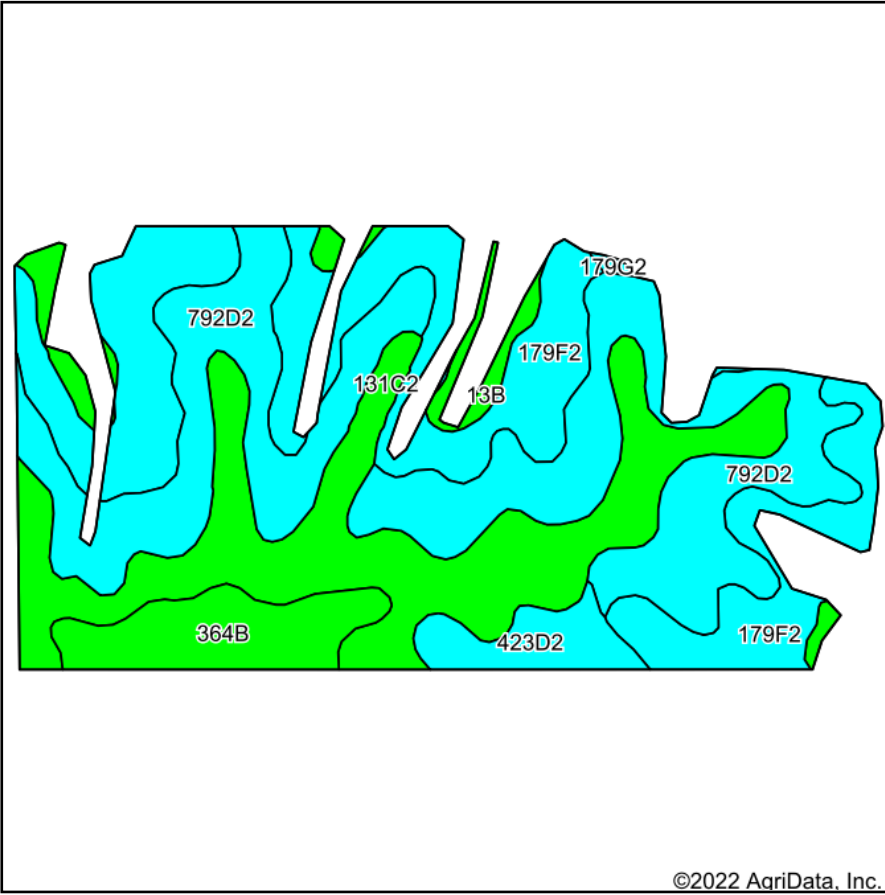

State: **Iowa**  
 County: **Lucas**  
 Location: **20-73N-20W**  
 Township: **Pleasant**  
 Acres: **62.55**  
 Date: **9/29/2022**

**Hawkeye Farm Mgmt & Real Estate**

**United Country Real Estate**  
 22 N Main, Alto IA Phone: 515-952-7796  
 Cr:rl: hawkeye@ucia.com  
 Cr:rl: 595: ucio@ucio.com  
 www.iowawhitehillfarms.com

Maps Provided By:

**surety**  
 CUSTOMIZED ONLINE MAPPING  
 © AgriData, Inc. 2021 www.AgriDataInc.com



Soils data provided by USDA and NRCS.

Area Symbol: IA117, Soil Area Version: 30

Code	Soil Description	Acres	Percent of field	CSR2 Legend	Non-Irr Class *c	CSR2**	CSR	*n NCCPI Soybeans	
792D2	Armstrong clay loam, 9 to 14 percent slopes, moderately eroded	20.94	33.5%		IVe	5	13	40	
179F2	Gara clay loam, 18 to 25 percent slopes, moderately eroded	17.58	28.1%		IVe	11	13	35	
131C2	Pershing silty clay loam, 5 to 9 percent slopes, moderately eroded	15.23	24.3%		IIIe	62	45	57	
364B	Grundy silty clay loam, 2 to 5 percent slopes	4.19	6.7%		Ile	72	75	69	
423D2	Bucknell silty clay loam, 9 to 14 percent slopes, moderately eroded	2.27	3.6%		IVe	6	13	44	
13B	Zook-Olmitz-Vesser complex, 0 to 5 percent slopes	2.21	3.5%		IIw	68	53	74	
179G2	Gara clay loam, 25 to 40 percent slopes, moderately eroded	0.13	0.2%		VIIe	5	5	8	
<b>Weighted Average</b>						<b>3.56</b>	<b>27.3</b>	<b>26.3</b>	<b>*n 46</b>

\*\*IA has updated the CSR values for each county to CSR2.

\*n: The aggregation method is "Weighted Average using all components"

\*c: Using Capabilities Class Dominant Condition Aggregation Method

Soils data provided by USDA and NRCS.