

# Soils Map

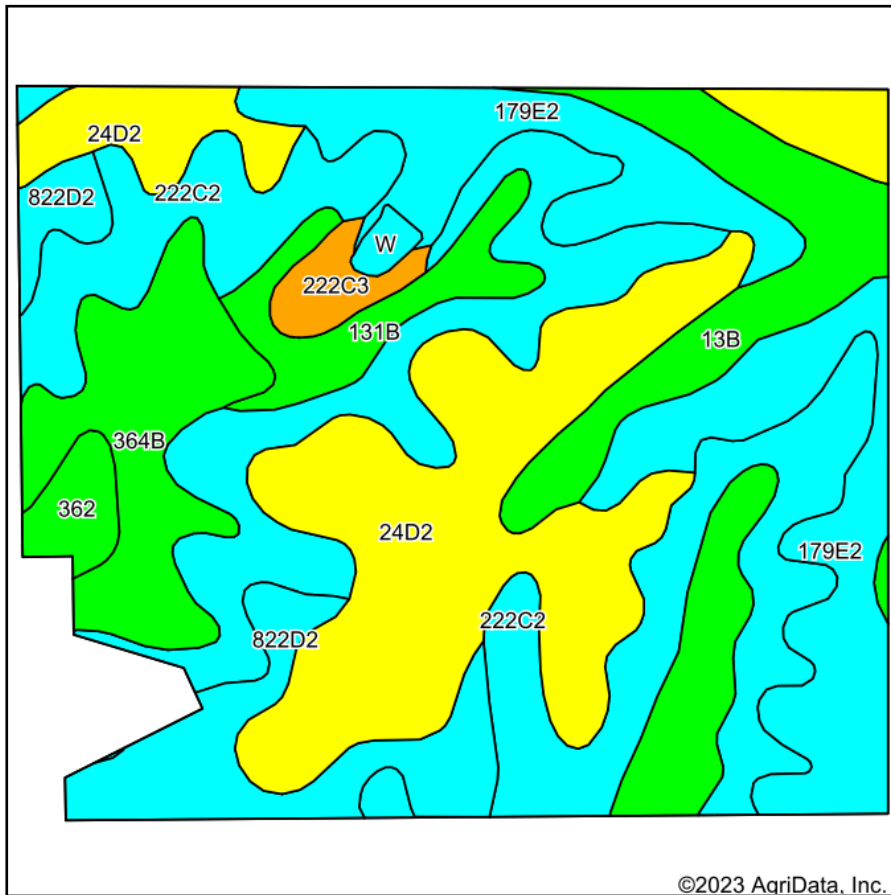

Soils data provided by USDA and NRCS.

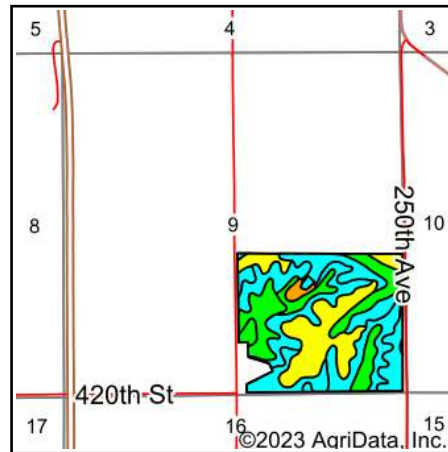

State: **Iowa**  
 County: **Appanoose**  
 Location: **9-70N-17W**  
 Township: **Taylor**  
 Acres: **121**  
 Date: **1/26/2023**

**Hawkeye Farm Mgmt & Real Estate**



22 N Main, Albia IA Phone: 562-952-7796  
 Cell: 562-952-7796  
 Fax: 562-952-7796  
 www.iowawhitehillfarms.com

Maps Provided By:



Area Symbol: IA007, Soil Area Version: 29

Code	Soil Description	Acres	Percent of field	CSR2 Legend	Non-Irr Class *c	CSR2**	CSR	*n NCCPI Soybeans	
222C2	Clarinda silty clay loam, 5 to 9 percent slopes, moderately eroded	32.31	26.7%		IVw	28	25	42	
24D2	Shelby loam, 9 to 14 percent slopes, moderately eroded	28.69	23.7%		IIIe	45	48	52	
179E2	Gara loam, 14 to 18 percent slopes, moderately eroded	18.98	15.7%		VIe	24	33	44	
364B	Grundy silty clay loam, 2 to 5 percent slopes	14.24	11.8%		Ile	72	75	68	
822D2	Lamoni silty clay loam, 9 to 14 percent slopes, moderately eroded	9.37	7.7%		IVe	10	15	49	
13B	Olmitz-Vesser-Colo complex, 2 to 5 percent slopes	8.80	7.3%		IIw	79	68	80	
131B	Pershing silt loam, 2 to 5 percent slopes	4.38	3.6%		IIIe	70	67	59	
362	Haig silty clay loam, 0 to 2 percent slopes	1.87	1.5%		IIw	83	70	63	
222C3	Clarinda soils, 5 to 9 percent slopes, severely eroded	1.80	1.5%		VIe	31	15	28	
W	Water	0.56	0.5%			0	0		
<b>Weighted Average</b>						<b>*-</b>	<b>41.2</b>	<b>41.9</b>	<b>*n 51.6</b>

\*\*IA has updated the CSR values for each county to CSR2.

\*n: The aggregation method is "Weighted Average using all components"

\*c: Using Capabilities Class Dominant Condition Aggregation Method

\*- Non Irr Class weighted average cannot be calculated on the current soils data due to missing data.

Soils data provided by USDA and NRCS.