

# Soils Map

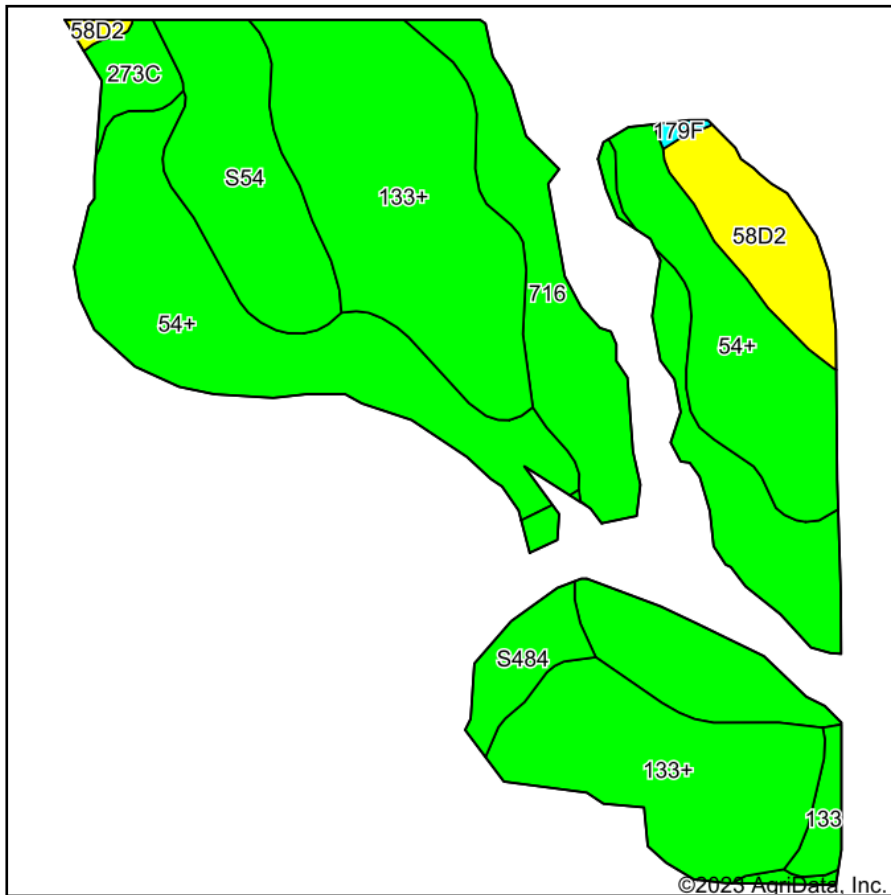

Soils data provided by USDA and NRCS.

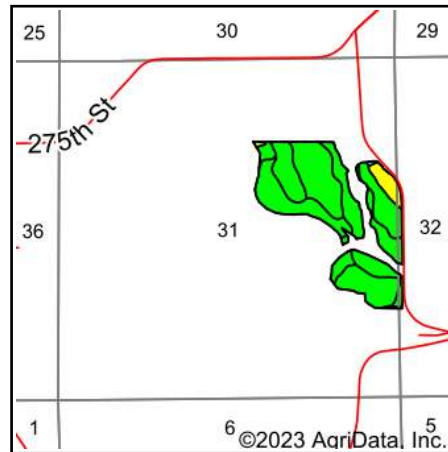

State: **Iowa**  
 County: **Monroe**  
 Location: **31-71N-16W**  
 Township: **Urbana**  
 Acres: **71.13**  
 Date: **1/27/2023**

**Hawkeye Farm Mgmt & Real Estate**

**United Country Real Estate**  
 22 N Main, Albia IA Phone: 562-7796  
 Cr:rl@hawkeyerealestate.com  
 Cr:rl@uwr: www.uwr.com  
 www.iowawhitehillfarms.com

Maps Provided By:

**surety**  
 CUSTOMIZED ONLINE MAPPING  
 © AgriData, Inc. 2021 www.AgriDataInc.com



Area Symbol: IA135, Soil Area Version: 30

Code	Soil Description	Acres	Percent of field	CSR2 Legend	Non-Irr Class *c	CSR2**	CSR	*n NCCPI Soybeans	
133+	Colo silt loam, overwash, 0 to 2 percent slopes	22.26	31.3%		Ilw	78	80	87	
54+	Zook silt loam, heavy till, 0 to 2 percent slopes, occasionally flooded, overwash	18.52	26.0%		Ilw	68	70	73	
716	Lawson-Quiver-Nodaway complex, 0 to 2 percent slopes, occasionally flooded	14.85	20.9%		Ilw	78		86	
S54	Zook silty clay loam, heavy till, 0 to 2 percent slopes, occasionally flooded	6.95	9.8%		Ilw	68		68	
58D2	Douds loam, heavy loess, 9 to 14 percent slopes, moderately eroded	3.90	5.5%		Ive	44	28	63	
S484	Lawson silt loam, heavy till, 0 to 2 percent slopes, occasionally flooded	2.21	3.1%		Ilw	86		93	
273C	Olmitz loam, heavy till, 5 to 9 percent slopes	1.36	1.9%		Ille	77	57	71	
133	Colo silty clay loam, heavy till, 0 to 2 percent slopes, occasionally flooded	0.91	1.3%		Ilw	78	85	86	
179F	Gara loam, 18 to 25 percent slopes	0.17	0.2%		Vle	19	15	42	
<b>Weighted Average</b>						<b>2.14</b>	<b>72.6</b>	<b>*-</b>	<b>*n 79.7</b>

\*\*IA has updated the CSR values for each county to CSR2.

\*- CSR weighted average cannot be calculated on the current soils data, use prior data version for csr values.

\*n: The aggregation method is "Weighted Average using all components"

\*c: Using Capabilities Class Dominant Condition Aggregation Method

Soils data provided by USDA and NRCS.