

Soils Map

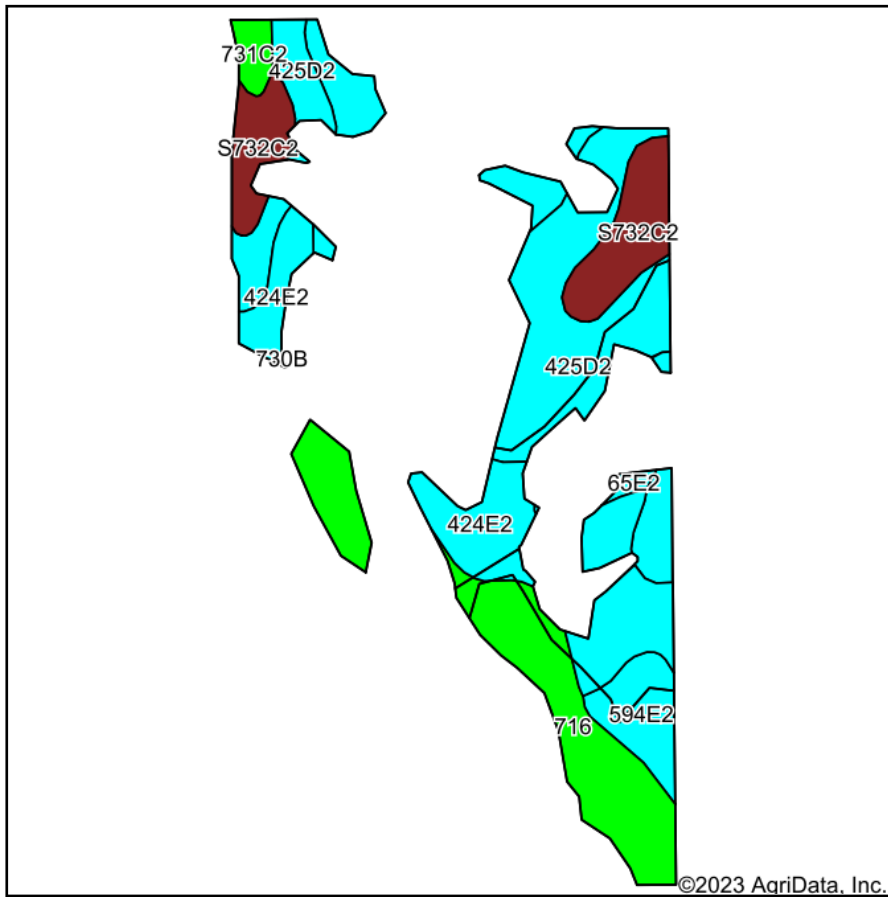

Soils data provided by USDA and NRCS.

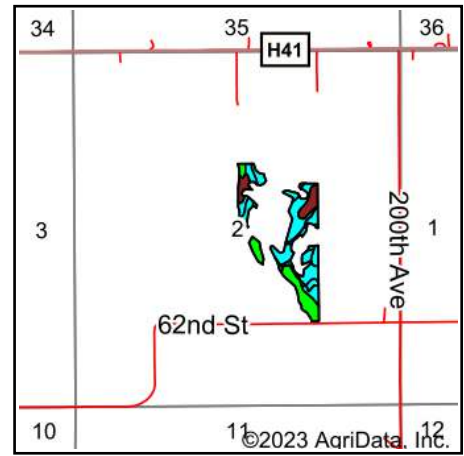

State: **Iowa**
 County: **Wapello**
 Location: **2-71N-15W**
 Township: **Adams**
 Acres: **24.22**
 Date: **3/13/2023**

Hawkeye Farm Mgmt & Real Estate

22 N Main, Albia IA Phone: 561-952-7796
 Cell: 561-952-7796
 Email: hawkeyefarm@hawkeyefarm.com
 www.hawkeyefarm.com

Maps Provided By:

surety
 CUSTOMIZED ONLINE MAPPING
 © AgriData, Inc. 2023 www.AgriDataInc.com



Area Symbol: IA179, Soil Area Version: 31

Code	Soil Description	Acres	Percent of field	CSR2 Legend	Non-Irr Class *c	CSR2**	CSR	*n NCCPI Soybeans
425D2	Keswick loam, 9 to 14 percent slopes, moderately eroded	7.08	29.2%		IVe	9	5	36
716	Lawson-Quiver-Nodaway complex, 0 to 2 percent slopes, occasionally flooded	5.32	22.0%		IIw	78		86
424E2	Lindley-Keswick loams, 14 to 18 percent slopes, moderately eroded	4.99	20.6%		VIe	24	5	45
S732C2	Weller silty clay loam, 5 to 9 percent slopes, moderately eroded	3.15	13.0%		IIIe	59		67
65E2	Lindley loam, 14 to 18 percent slopes, moderately eroded	1.69	7.0%		VIe	29	28	53
594E2	Galland loam, heavy loess, 14 to 18 percent slopes, moderately eroded	1.50	6.2%		VIe	6	5	38
731C2	Pershing silty clay loam, 5 to 9 percent slopes, moderately eroded	0.49	2.0%		IIIe	62	40	56
Weighted Average					4.09	36	*-	*n 54.6

**IA has updated the CSR values for each county to CSR2.

*- CSR weighted average cannot be calculated on the current soils data, use prior data version for csr values.

*n: The aggregation method is "Weighted Average using all components"

*c: Using Capabilities Class Dominant Condition Aggregation Method

Soils data provided by USDA and NRCS.