

Soils Map

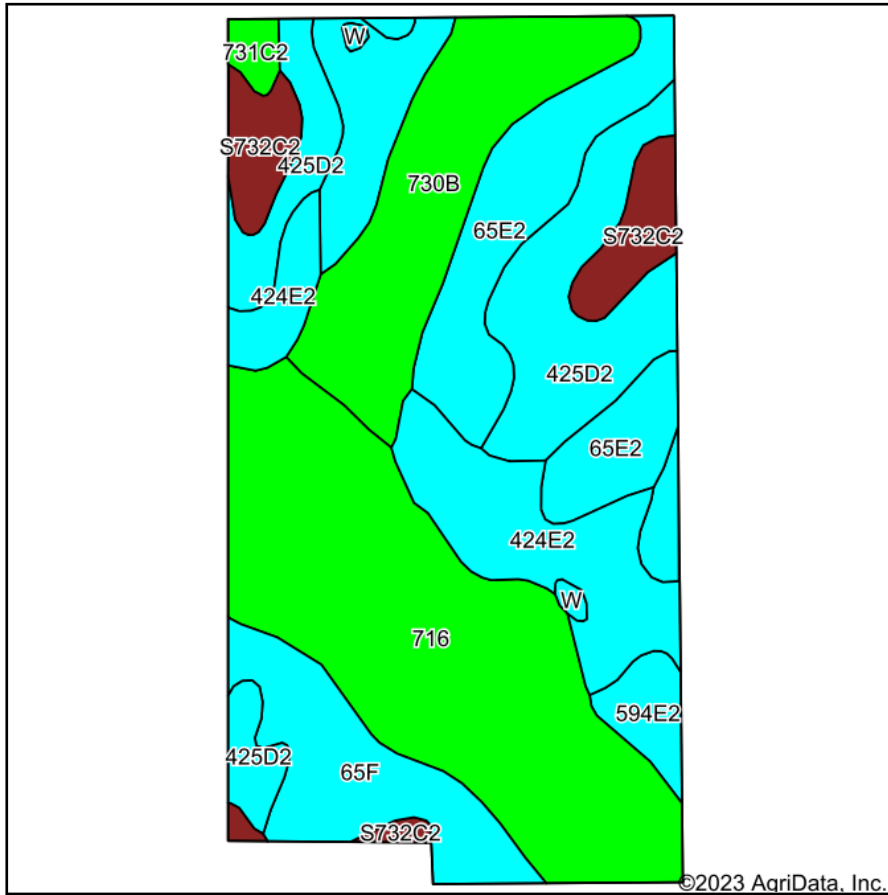

Soils data provided by USDA and NRCS.

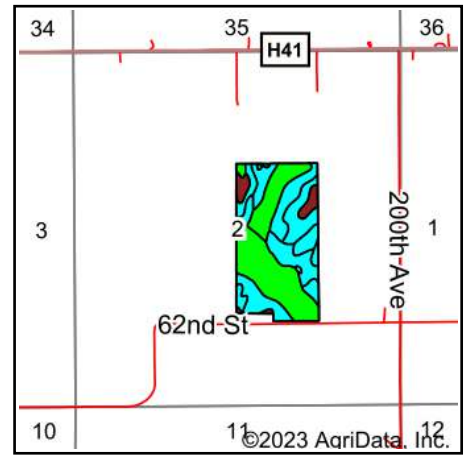

State: **Iowa**
 County: **Wapello**
 Location: **2-71N-15W**
 Township: **Adams**
 Acres: **76**
 Date: **3/13/2023**

Hawkeye Farm Mgmt & Real Estate

22 N Main, Alto IA Phone: 561-952-7796
 Cell: 561-952-7796
 Email: hawkeyefarm@hawkeyefarm.com
 www.hawkeyefarm.com

Maps Provided By:

surety
 CUSTOMIZED ONLINE MAPPING
 © AgriData, Inc. 2023 www.AgriDataInc.com



Area Symbol: IA179, Soil Area Version: 31

Code	Soil Description	Acres	Percent of field	CSR2 Legend	Non-Irr Class *c	CSR2**	CSR	*n NCCPI Soybeans
716	Lawson-Quiver-Nodaway complex, 0 to 2 percent slopes, occasionally flooded	21.53	28.3%		Ilw	78		86
65E2	Lindley loam, 14 to 18 percent slopes, moderately eroded	12.31	16.2%		Vle	29	28	53
425D2	Keswick loam, 9 to 14 percent slopes, moderately eroded	11.33	14.9%		IVe	9	5	36
730B	Nodaway-Cantril complex, 2 to 5 percent slopes	9.79	12.9%		Ilw	80	63	65
424E2	Lindley-Keswick loams, 14 to 18 percent slopes, moderately eroded	8.29	10.9%		Vle	24	5	45
65F	Lindley loam, 18 to 25 percent slopes	6.21	8.2%		Vlle	17	10	48
S732C2	Weller silty clay loam, 5 to 9 percent slopes, moderately eroded	4.10	5.4%		Ille	59		67
594E2	Galland loam, heavy loess, 14 to 18 percent slopes, moderately eroded	1.51	2.0%		Vle	6	5	38
731C2	Pershing silty clay loam, 5 to 9 percent slopes, moderately eroded	0.65	0.9%		Ille	62	40	56
W	Water	0.28	0.4%			0	0	
Weighted Average					*-	46.3	*-	*n 60.4

**IA has updated the CSR values for each county to CSR2.

*- CSR weighted average cannot be calculated on the current soils data, use prior data version for csr values.

*n: The aggregation method is "Weighted Average using all components"

*c: Using Capabilities Class Dominant Condition Aggregation Method

*- Non Irr Class weighted average cannot be calculated on the current soils data due to missing data.

Soils data provided by USDA and NRCS.