

Soils Map

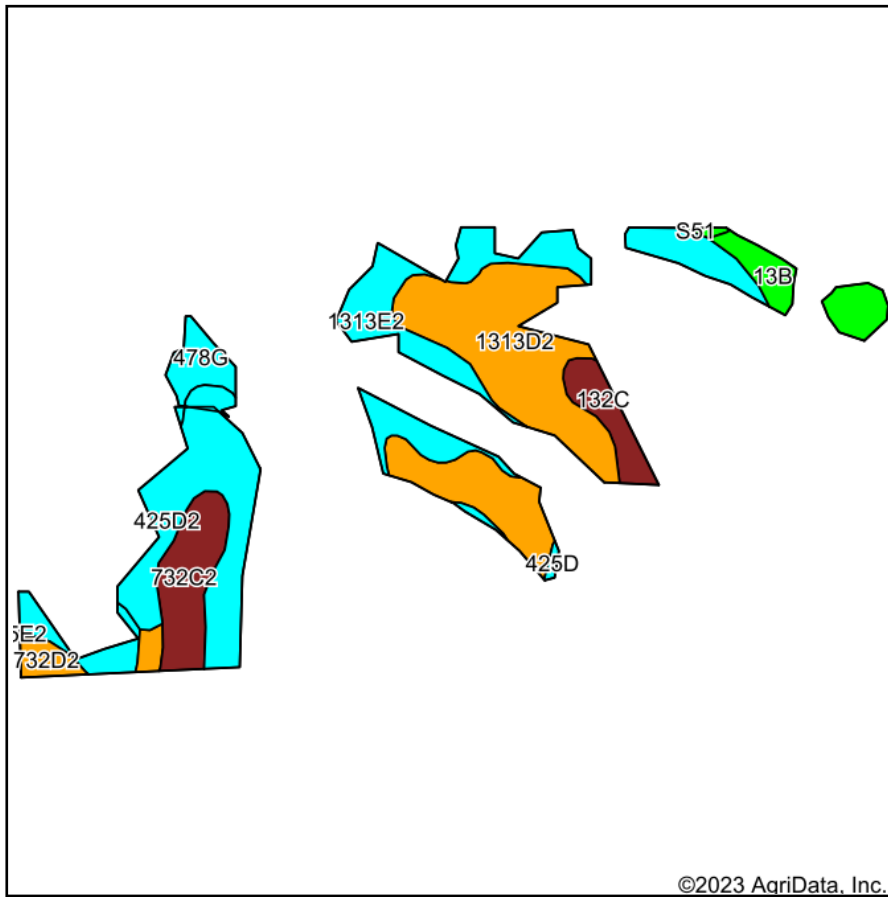

Soils data provided by USDA and NRCS.

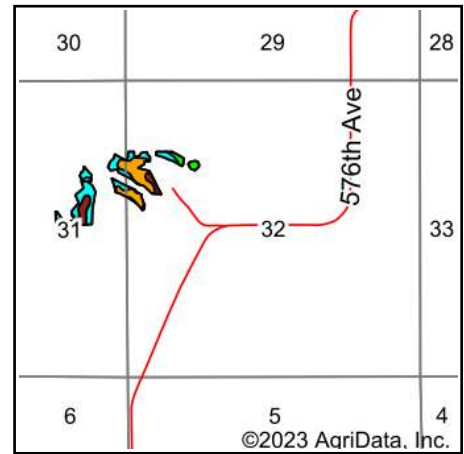

State: **Iowa**
 County: **Monroe**
 Location: **32-73N-18W**
 Township: **Union**
 Acres: **18.98**
 Date: **3/27/2023**

Hawkeye Farm Mgmt & Real Estate

22 N Main, Alto IA Phone: 561-952-7796
 Cell: 561-952-7796
 Email: hawkeyefarm@hawkeyefarm.com
 Website: www.hawkeyefarm.com

Maps Provided By:

surety
 CUSTOMIZED ONLINE MAPPING
 © AgriData, Inc. 2023 www.AgriDataInc.com



Area Symbol: IA135, Soil Area Version: 30

Code	Soil Description	Acres	Percent of field	CSR2 Legend	Non-Irr Class *c	CSR2**	CSR	*n NCCPI Soybeans
1313D2	Munterville silt loam, 9 to 14 percent slopes, moderately eroded	6.07	32.0%		VIe	34	10	42
1313E2	Munterville silt loam, 14 to 18 percent slopes, moderately eroded	3.83	20.2%		VIe	22	5	39
425D2	Keswick loam, 9 to 14 percent slopes, moderately eroded	3.42	18.0%		IVe	9	12	36
732C2	Weller silty clay loam, 5 to 9 percent slopes, moderately eroded	1.67	8.8%		IIIe	59	40	67
478G	Munterville-Rock outcrop complex, 14 to 40 percent slopes	1.30	6.8%		VIIe	5	5	6
13B	Olmitz-Colo-Vesser complex, 2 to 5 percent slopes	1.13	6.0%		IIw	82	60	71
132C	Weller silt loam, 5 to 9 percent slopes	0.85	4.5%		IIIe	59	44	73
732D2	Weller silty clay loam, 9 to 14 percent slopes, moderately eroded	0.59	3.1%		IVe	34	28	63
S51	Vesser silt loam, 0 to 2 percent slopes, occasionally flooded	0.06	0.3%		IIw	75		94
425D	Keswick loam, 9 to 14 percent slopes	0.06	0.3%		IVe	8	16	44
Weighted Average					4.99	31.3	*-	*n 44

**IA has updated the CSR values for each county to CSR2.

*- CSR weighted average cannot be calculated on the current soils data, use prior data version for csr values.

*n: The aggregation method is "Weighted Average using all components"

*c: Using Capabilities Class Dominant Condition Aggregation Method

Soils data provided by USDA and NRCS.