

# Soils Map

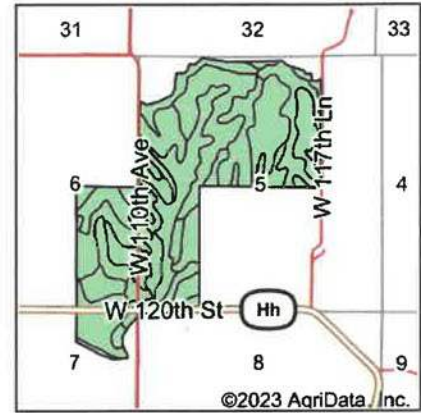
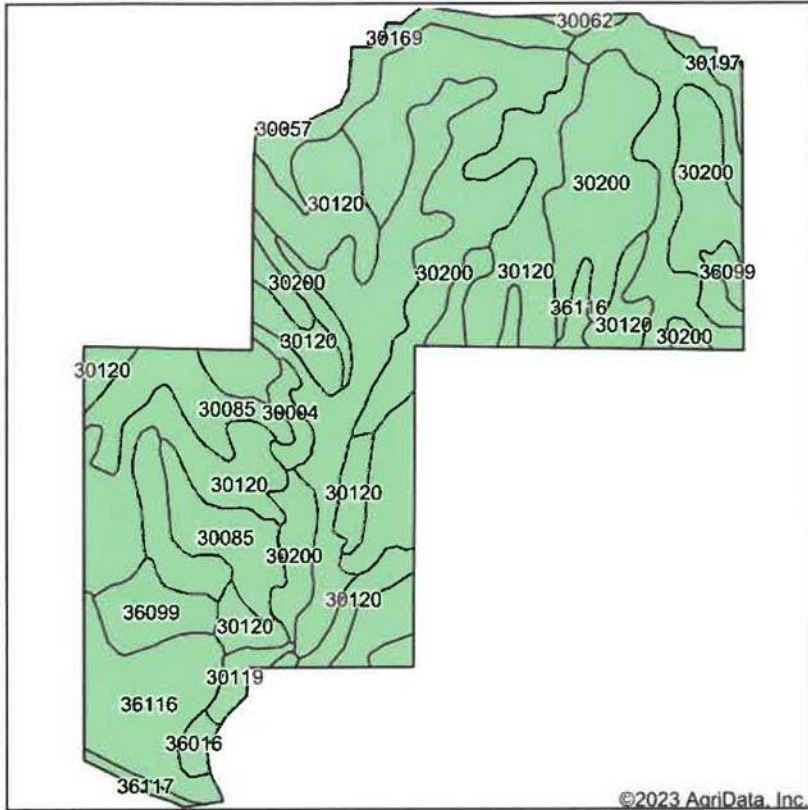

State: **Missouri**  
 County: **Harrison**  
 Location: **5-66N-29W**  
 Township: **Lincoln**  
 Acres: **403.44**  
 Date: **7/25/2023**

**United Country**  
 NELSON REAL ESTATE

Maps Provided By:  
**surety**  
 CUSTOMIZED ONLINE MAPPING  
 © AgriData, Inc. 2023 www.AgriDataInc.com



Soils data provided by USDA and NRCS.

©2023 AgriData, Inc.

Area Symbol: MO081, Soil Area Version: 26

Code	Soil Description	Acres	Percent of field	Non-Irr Class *c	Alfalfa hay Tons	Caucasian bluestem Tons	Common bermudagrass Tons	Orchardgrass red clover Tons	Tall fescue Tons	Warm season grasses Tons
30200	Shelby loam, 9 to 14 percent slopes	114.47	28.4%	IIIe						
30120	Lagonda silty clay loam, 5 to 9 percent slopes, eroded	98.34	24.4%	IIIe	5	8	7	8	7	8
30085	Grundy silt loam, 2 to 5 percent slopes	77.15	19.1%	Ile						
36099	Zook-Colo silty clay loams, 1 to 3 percent slopes, frequently flooded	52.52	13.0%	IIIw			8	7	8	9
36116	Zook silty clay loam, heavy till, 0 to 2 percent slopes, occasionally flooded	29.67	7.4%	IIw						
30169	Pershing silt loam, 5 to 9 percent slopes	14.53	3.6%	IIIe						
30004	Adair clay loam, heavy till, 5 to 9 percent slopes, moderately eroded	3.84	1.0%	IIIe						
30119	Lagonda silty clay loam, 2 to 5 percent slopes, eroded	3.75	0.9%	IIIe						
30197	Shelby loam, 14 to 18 percent slopes	2.93	0.7%	IVe						

Soils data provided by USDA and NRCS.