

Soils Map

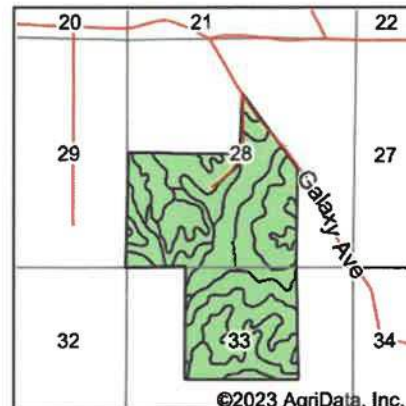
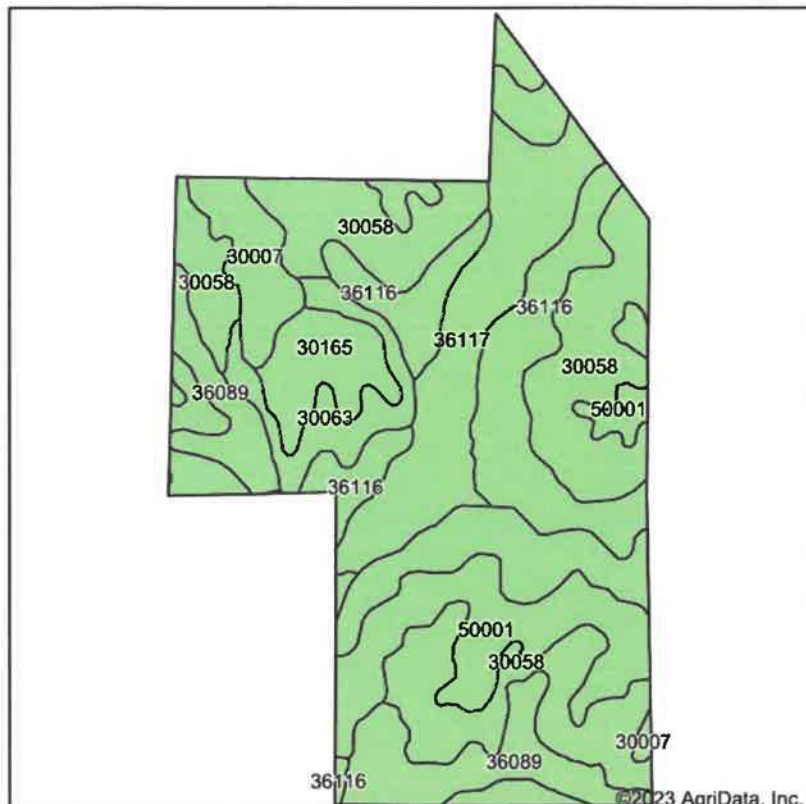

State: **Missouri**
 County: **Mercer**
 Location: **28-65N-25W**
 Township: **Harrison**
 Acres: **414.36**
 Date: **5/17/2023**

United Country
 NELSON REAL ESTATE

Maps Provided By:

surety
 CUSTOMER ONLINE MAPPING
 © AgriData, Inc. 2023 www.AgriDataInc.com



Soils data provided by USDA and NRCS.

Area Symbol: MO129, Soil Area Version: 24

Code	Soil Description	Acres	Percent of field	Non-Irr Class *c	Alfalfa hay Tons	Caucasian bluestem Tons	Common bermudagrass Tons	Corn	Corn Bu	Grain sorghum Bu	Orchardgrass red clover Tons	Soybeans Bu	Tall fescue Tons	Warm season grasses Tons	Winter wheat Bu
30058	Gara loam, 14 to 18 percent slopes, moderately eroded	154.61	37.3%	Vle											
36116	Zook silty clay loam, heavy till, 0 to 2 percent slopes, occasionally flooded	59.83	14.4%	Ilw											
36117	Nodaway silt loam, heavy till, 0 to 2 percent slopes, occasionally flooded	52.76	12.7%	Ilw											
50001	Armstrong loam, 5 to 9 percent slopes, eroded	46.98	11.3%	Ille	5	8	7	4	4	4	8	2	7	8	2

Soils data provided by USDA and NRCS.