

Soils Map

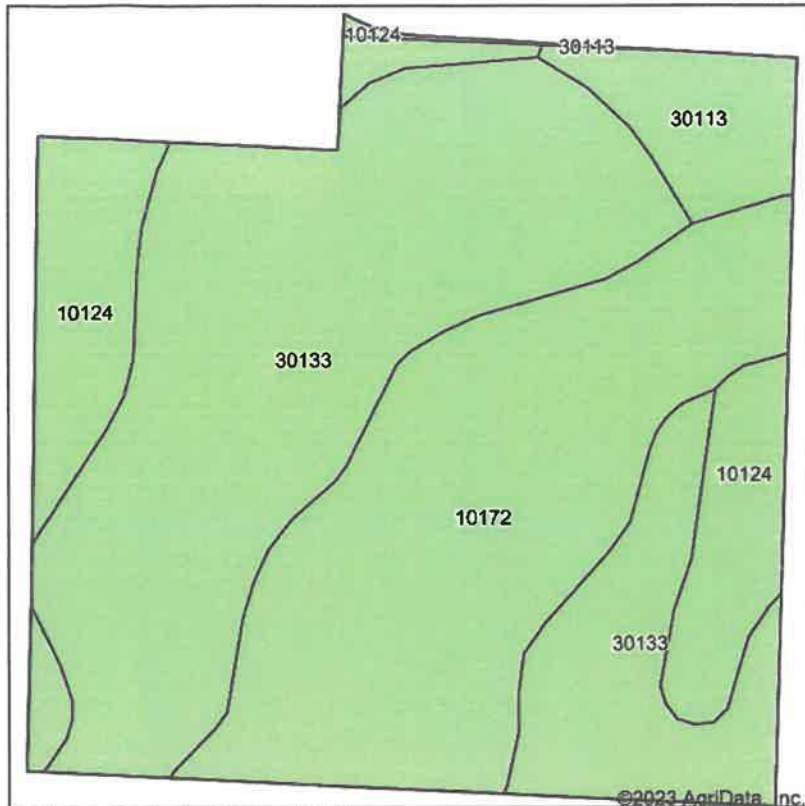

Soils data provided by USDA and NRCS.

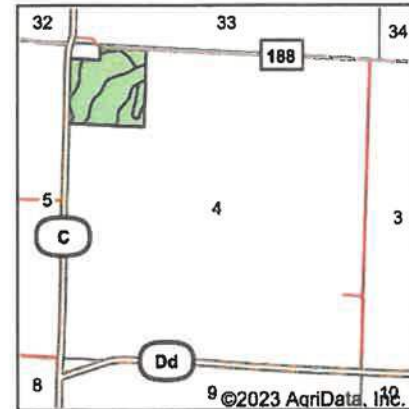

State: **Missouri**
 County: **Gentry**
 Location: **4-64N-30W**
 Township: **Howard**
 Acres: **36.5**
 Date: **4/15/2023**

United Country
 NELSON REAL ESTATE

Maps Provided By:

surety
 CUSTOMER ONLINE SUPPORT
 © AgriData, Inc. 2023 www.AgriDataInc.com



Area Symbol: MO075, Soil Area Version: 25
 Area Symbol: MO227, Soil Area Version: 24

Code	Soil Description	Acres	Percent of field	Non-Irr Class *c
30133	Lamoni clay loam, 5 to 9 percent slopes, eroded	17.99	49.3%	IIIe
10172	Shelby clay loam, 9 to 14 percent slopes, moderately eroded	11.52	31.6%	IIIe
10124	Sharpsburg silty clay loam, loess hill, 2 to 5 percent slopes	5.03	13.8%	Ile
30113	Lagonda and Clarinda soils, 5 to 11 percent slopes, eroded	1.88	5.2%	IIIe
10124	Sharpsburg silty clay loam, loess hill, 2 to 5 percent slopes	0.08	0.2%	Ile
Weighted Average				2.86

*c: Using Capabilities Class Dominant Condition Aggregation Method