

# Soils Map

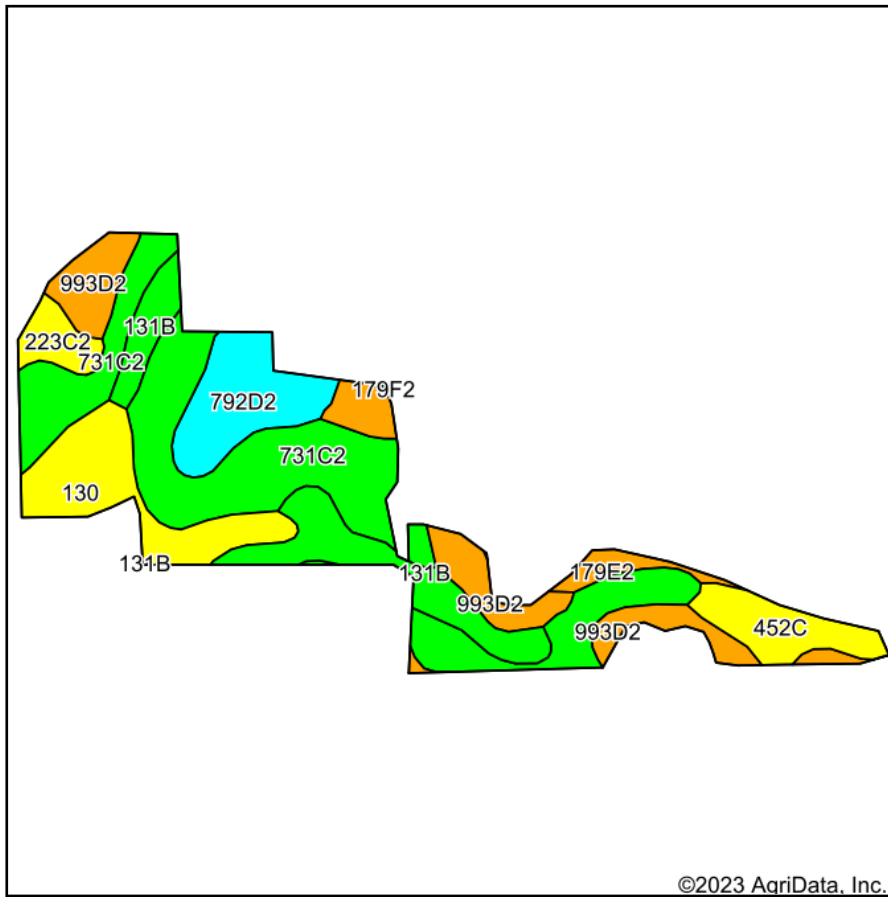

Soils data provided by USDA and NRCS.

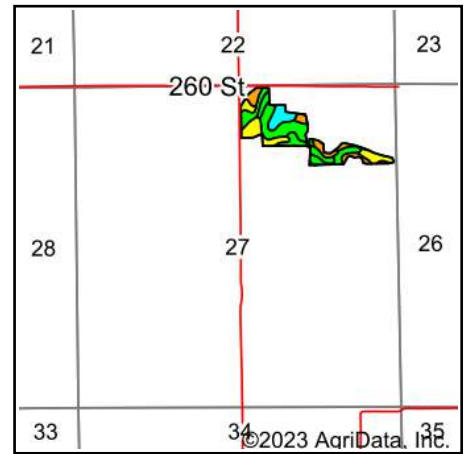

State: **Iowa**  
 County: **Monroe**  
 Location: **27-71N-17W**  
 Township: **Monroe**  
 Acres: **24.18**  
 Date: **8/9/2023**

**Hawkeye Farm Mgmt & Real Estate**

22 N Main, Alto, IA Phone: 561-952-7796  
 Cell: 561-952-7796  
 Email: hawkeyefarm@icloud.com  
 www.hawkeyefarm.com

Maps Provided By:

**surety**  
 CUSTOMIZED ONLINE MAPPING  
 © AgriData, Inc. 2023 www.AgriDataInc.com



Area Symbol: IA135, Soil Area Version: 30

Code	Soil Description	Acres	Percent of field	CSR2 Legend	Non-Irr Class *c	CSR2**	CSR	*n NCCPI Corn	*n NCCPI Soybeans
731C2	Pershing silty clay loam, 5 to 9 percent slopes, moderately eroded	7.06	29.2%		IIIe	62	45	68	56
993D2	Gara-Armstrong loams, 9 to 14 percent slopes, moderately eroded	3.61	14.9%		IVe	35	20	66	48
131B	Pershing silt loam, 2 to 5 percent slopes	3.13	12.9%		IIIe	70	67	74	59
130	Belinda silt loam, 0 to 2 percent slopes	2.97	12.3%		IIIw	47	63	73	57
792D2	Armstrong loam, 9 to 14 percent slopes, moderately eroded	2.47	10.2%		IVe	9	13	62	43
131C	Pershing silt loam, 5 to 9 percent slopes	2.08	8.6%		IIIe	65	49	72	58
452C	Lineville silt loam, 5 to 9 percent slopes	1.57	6.5%		IIIe	48	35	73	55
223C2	Rinda silty clay loam, 5 to 9 percent slopes, moderately eroded	0.78	3.2%		IVw	45	22	60	46
179E2	Gara loam, 14 to 18 percent slopes, moderately eroded	0.51	2.1%		VIe	35	33	68	51
<b>Weighted Average</b>					<b>3.35</b>	<b>50</b>	<b>41.8</b>	<b>*n 68.9</b>	<b>*n 53.7</b>

\*\*IA has updated the CSR values for each county to CSR2.

\*n: The aggregation method is "Weighted Average using all components"

\*c: Using Capabilities Class Dominant Condition Aggregation Method

Soils data provided by USDA and NRCS.