

# Soils Map

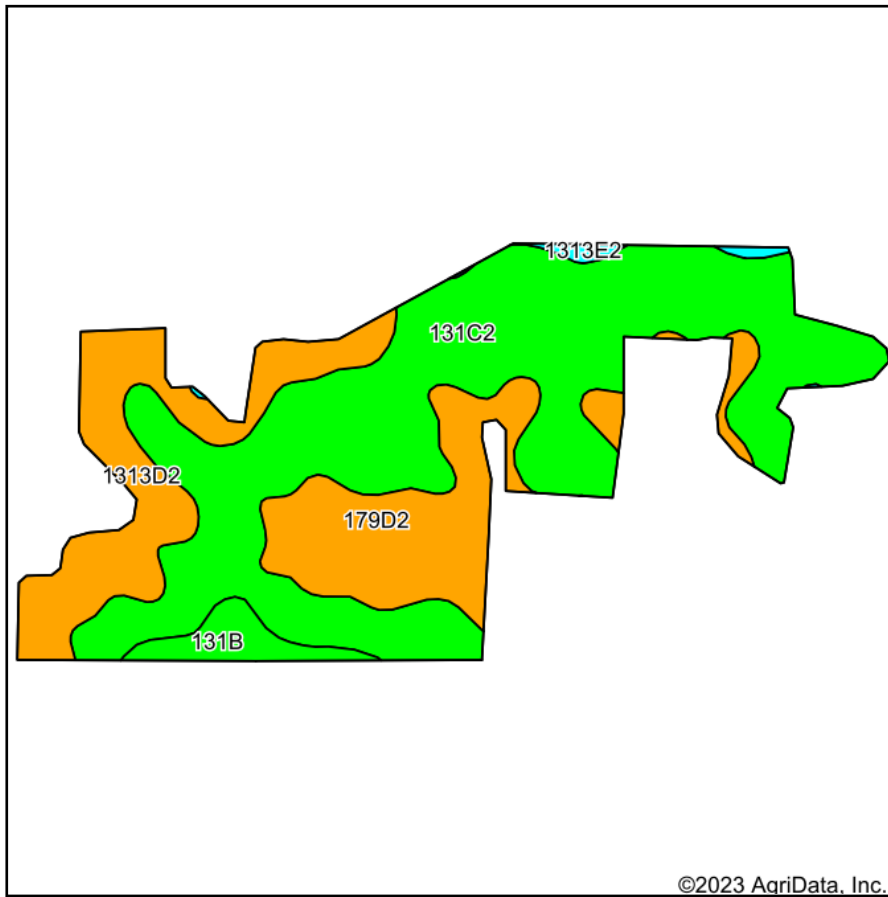

Soils data provided by USDA and NRCS.

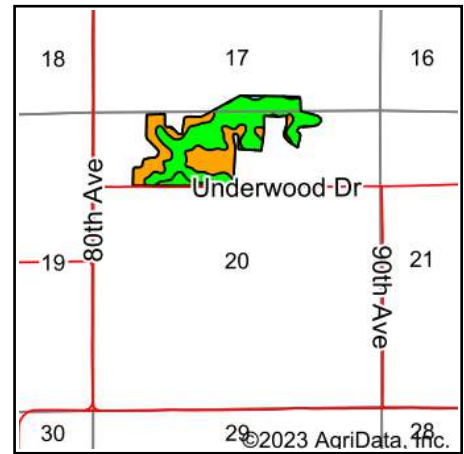

State: **Iowa**  
 County: **Marion**  
 Location: **17-74N-20W**  
 Township: **Washington**  
 Acres: **66.88**  
 Date: **9/20/2023**

**Hawkeye Farm Mgmt & Real Estate**

22 N Main, Alto IA Phone: 561-952-7796  
 Cell: 561-952-7796  
 Email: hawkeyefarm@hawkeyefarm.com  
 Website: www.hawkeyefarm.com

Maps Provided By:

**surety**  
 CUSTOMIZED ONLINE MAPPING  
 © AgriData, Inc. 2023 www.AgriDataInc.com



Area Symbol: IA125, Soil Area Version: 32

Code	Soil Description	Acres	Percent of field	CSR2 Legend	Non-Irr Class *c	CSR2**	CSR	*n NCCPI Corn	*n NCCPI Soybeans
131C2	Pershing silt loam, 5 to 9 percent slopes, moderately eroded	40.14	60.0%		IIIe	62	49	68	51
179D2	Gara loam, 9 to 14 percent slopes, moderately eroded	12.30	18.4%		IVe	38	43	67	48
1313D2	Munterville silt loam, 9 to 14 percent slopes, moderately eroded	11.52	17.2%		VIe	34	10	59	42
131B	Pershing silt loam, 2 to 5 percent slopes	2.30	3.4%		IIIe	70	72	74	59
1313E2	Munterville silt loam, 14 to 18 percent slopes, moderately eroded	0.62	0.9%		VIe	22	5	56	39
Weighted Average					3.73	52.7	41.6	*n 66.4	*n 49.1

\*\*IA has updated the CSR values for each county to CSR2.

\*n: The aggregation method is "Weighted Average using all components"

\*c: Using Capabilities Class Dominant Condition Aggregation Method

Soils data provided by USDA and NRCS.