

Soils Map

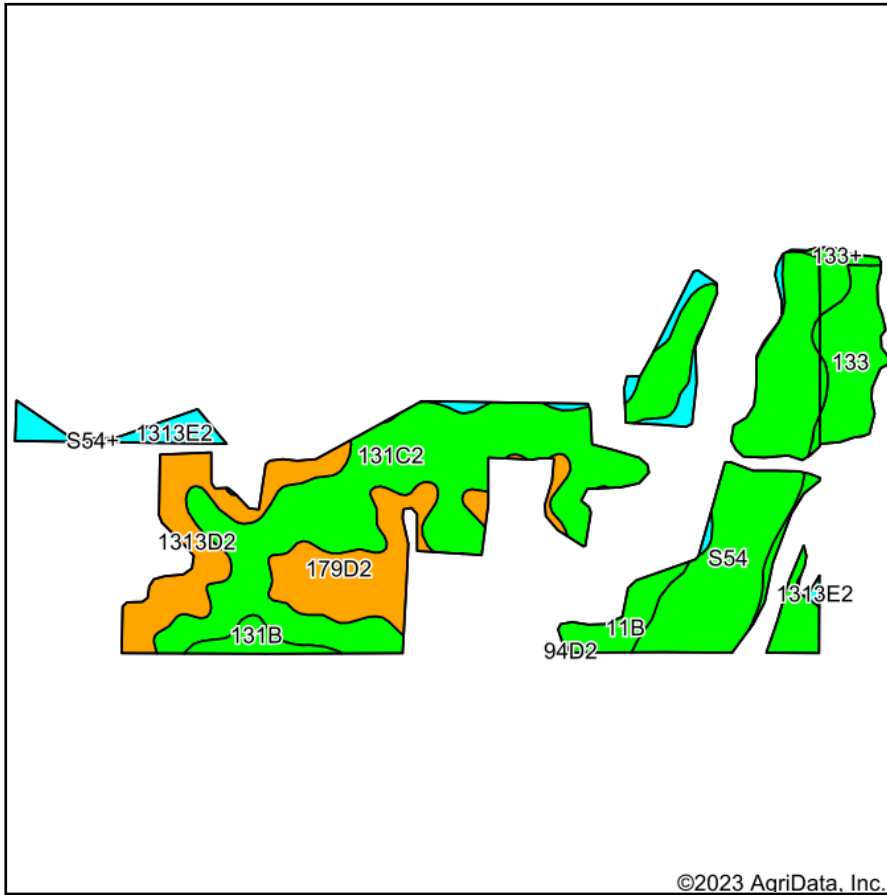

Soils data provided by USDA and NRCS.

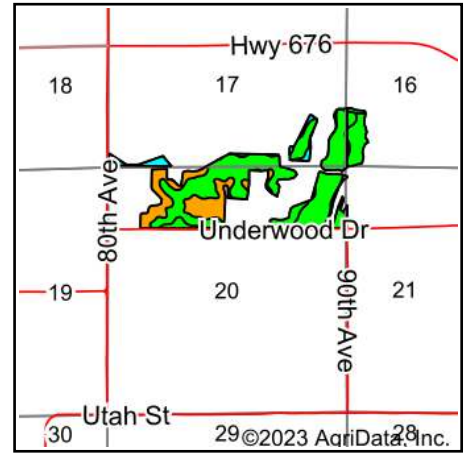

State: **Iowa**
 County: **Marion**
 Location: **20-74N-20W**
 Township: **Washington**
 Acres: **120.78**
 Date: **9/18/2023**

Hawkeye Farm Mgmt & Real Estate



22 N Main, Alto IA Phone: 561-952-7796
 Cell: 561-952-7796
 Email: hawkeyefarm@hawkeyefarm.com
 www.hawkeyefarm.com

Maps Provided By:



Area Symbol: IA125, Soil Area Version: 32

Code	Soil Description	Acres	Percent of field	CSR2 Legend	Non-Irr Class *c	CSR2**	CSR	*n NCCPI Corn	*n NCCPI Soybeans
131C2	Pershing silt loam, 5 to 9 percent slopes, moderately eroded	44.90	37.2%		IIIe	62	49	68	51
S54	Zook silty clay loam, heavy till, 0 to 2 percent slopes, occasionally flooded	26.59	22.0%		IIw	68		74	68
179D2	Gara loam, 9 to 14 percent slopes, moderately eroded	12.30	10.2%		IVe	38	43	67	48
133	Colo silty clay loam, deep loess, 0 to 2 percent slopes, occasionally flooded	11.96	9.9%		IIw	78	80	75	80
1313D2	Munterville silt loam, 9 to 14 percent slopes, moderately eroded	11.52	9.5%		VIe	34	10	59	42
1313E2	Munterville silt loam, 14 to 18 percent slopes, moderately eroded	6.53	5.4%		VIe	22	5	56	39
11B	Colo-Ely silty clay loams, 2 to 5 percent slopes	3.83	3.2%		IIe	81	65	84	79
131B	Pershing silt loam, 2 to 5 percent slopes	2.30	1.9%		IIIe	70	72	74	59
133+	Colo silt loam, deep loess, 0 to 2 percent slopes, overwash, occasionally flooded	0.72	0.6%		IIw	78	80	81	85
S54+	Zook silt loam, heavy till, 0 to 2 percent slopes, occasionally flooded, overwash	0.13	0.1%		IIw	68		66	73
Weighted Average					3.19	58.5	*n	69.1	*n 57.1

**IA has updated the CSR values for each county to CSR2.

*- CSR weighted average cannot be calculated on the current soils data, use prior data version for csr values.

*n: The aggregation method is "Weighted Average using all components"

*c: Using Capabilities Class Dominant Condition Aggregation Method

Soils data provided by USDA and NRCS.