

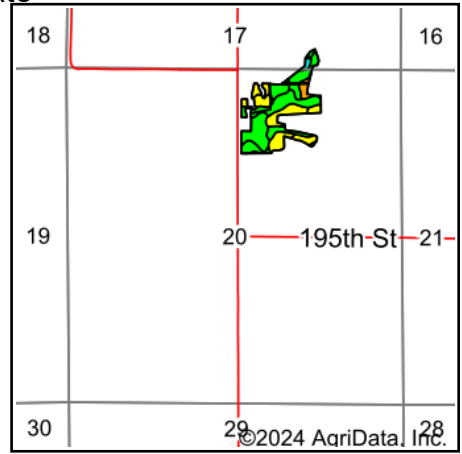

Soils Map

Boundary Lines Are Approximate

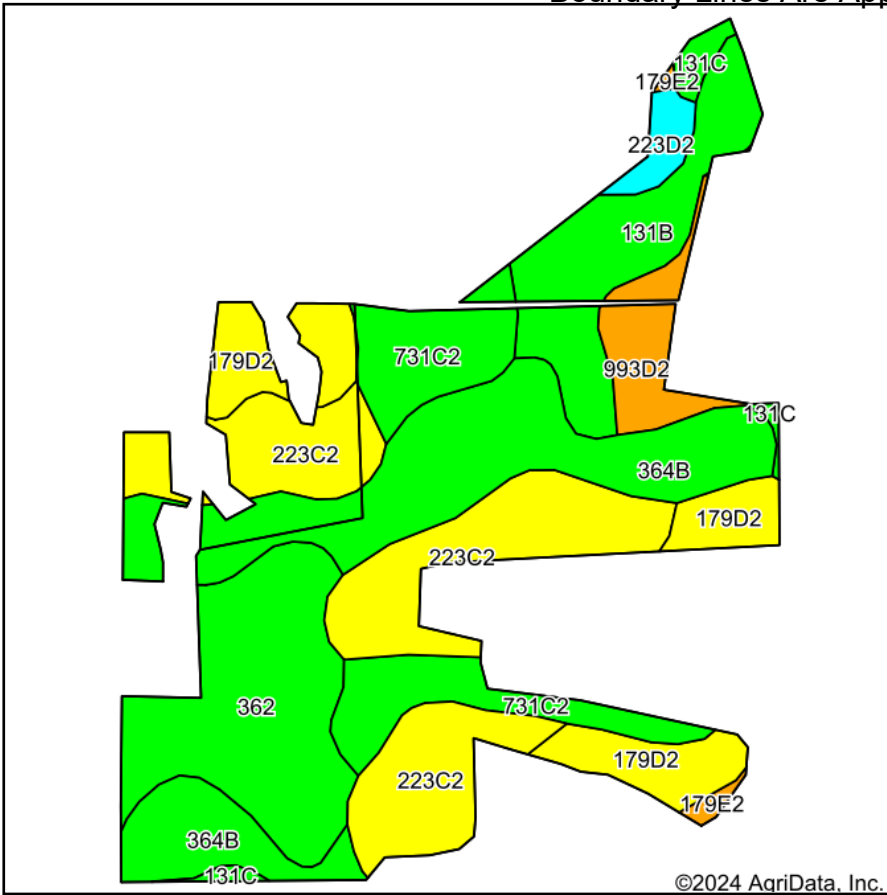

State: **Iowa**
 County: **Monroe**
 Location: **20-72N-19W**
 Township: **Wayne**
 Acres: **23.83**
 Date: **3/11/2024**

Hawkeye Farm Mgmt & Real Estate

 22 N Main, Alta IA Phone: 641-932-7796
 Email: hawkeye@uciowa.com
 On the web: www.uciowa.com; www.iowawhitetailfarms.com

Maps Provided By:



Soils data provided by USDA and NRCS.

Area Symbol: IA135, Soil Area Version: 31

Code	Soil Description	Acres	Percent of field	CSR2 Legend	Non-Irr Class *c	CSR2**	CSR	*n NCCPI Corn	*n NCCPI Soybeans	
364B	Grundy silty clay loam, 2 to 5 percent slopes	5.43	22.8%		Ile	72	75	79	68	
223C2	Rinda silty clay loam, 5 to 9 percent slopes, moderately eroded	5.34	22.4%		IVw	45	22	60	46	
362	Haig silty clay loam, 0 to 2 percent slopes	3.83	16.1%		IIw	83	70	73	63	
731C2	Pershing silty clay loam, 5 to 9 percent slopes, moderately eroded	2.62	11.0%		IIIe	62	45	68	56	
131B	Pershing silt loam, 2 to 5 percent slopes	2.50	10.5%		IIIe	70	67	74	59	
179D2	Gara loam, 9 to 14 percent slopes, moderately eroded	2.32	9.7%		IVe	43	43	70	53	
993D2	Gara-Armstrong loams, 9 to 14 percent slopes, moderately eroded	0.97	4.1%		IVe	35	20	66	48	
223D2	Rinda silty clay loam, 9 to 14 percent slopes, moderately eroded	0.37	1.6%		IVe	19	9	57	43	
131C	Pershing silt loam, 5 to 9 percent slopes	0.33	1.4%		IIIe	65	49	72	58	
179E2	Gara loam, 14 to 18 percent slopes, moderately eroded	0.12	0.5%		VIe	35	33	68	51	
Weighted Average						3.00	61	51.2	*n 70.1	*n 57.1

**IA has updated the CSR values for each county to CSR2.

*n: The aggregation method is "Weighted Average using all components"

*c: Using Capabilities Class Dominant Condition Aggregation Method

Soils data provided by USDA and NRCS.