

# Soils Map

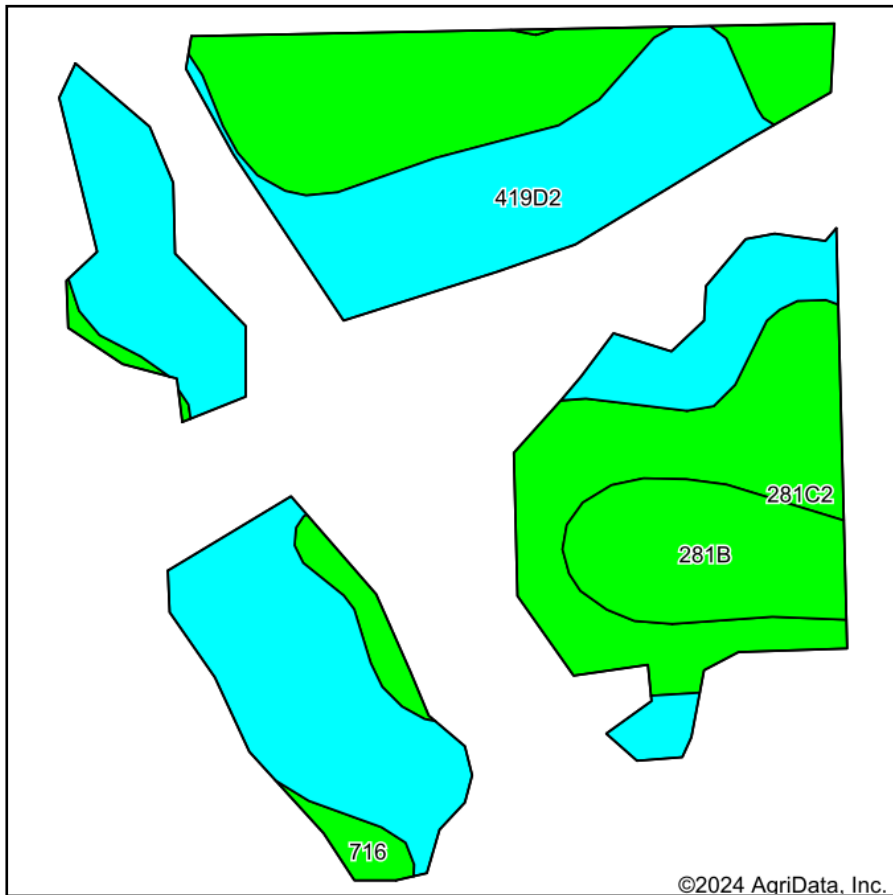

Soils data provided by USDA and NRCS.

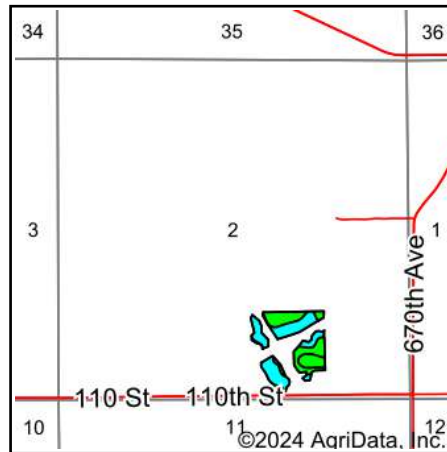

State: **Iowa**  
 County: **Monroe**  
 Location: **2-73N-17W**  
 Township: **Bluff Creek**  
 Acres: **15.65**  
 Date: **6/18/2024**

**Hawkeye Farm Mgmt & Real Estate**

**United Country Real Estate**  
 22 N Main, Albia IA Phone: 562-7796  
 Cr:rl: hawkeye@unitedcountry.com  
 Cr:rl: 562: 562:unitedcountry.com  
 www.iowawhitehillfarms.com

Maps Provided By:

**surety**  
 CUSTOMIZED ONLINE MAPPING  
 © AgriData, Inc. 2023 www.AgriDataInc.com



Area Symbol: IA135, Soil Area Version: 31

Code	Soil Description	Acres	Percent of field	CSR2 Legend	Non-Irr Class *c	CSR2**	CSR	*n NCCPI Corn	*n NCCPI Soybeans
419D2	Vanmeter silty clay loam, 9 to 14 percent slopes, moderately eroded	7.89	50.4%		Vle	5	15	38	30
281C2	Otley silty clay loam, 5 to 9 percent slopes, eroded	5.84	37.3%		Ille	82	70	83	65
281B	Otley silty clay loam, 2 to 5 percent slopes	1.61	10.3%		Ile	91	90	89	77
716	Lawson-Quiver-Nodaway complex, 0 to 2 percent slopes, occasionally flooded	0.31	2.0%		Ilw	78		79	86
<b>Weighted Average</b>						<b>4.39</b>	<b>44</b>	<b>*n 60.9</b>	<b>*n 49</b>

\*\*IA has updated the CSR values for each county to CSR2.

\*- CSR weighted average cannot be calculated on the current soils data, use prior data version for csr values.

\*n: The aggregation method is "Weighted Average using all components"

\*c: Using Capabilities Class Dominant Condition Aggregation Method

Soils data provided by USDA and NRCS.