

# Soils Map

Open Acres - Boundary Lines Are Approximate

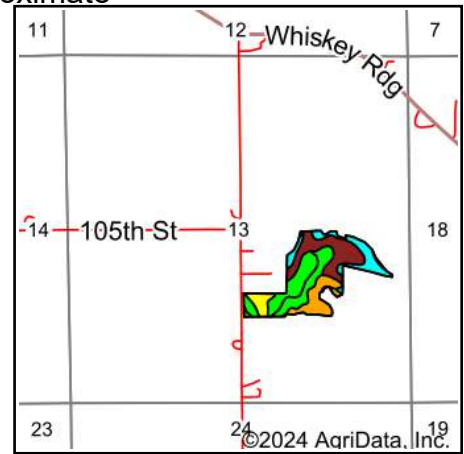
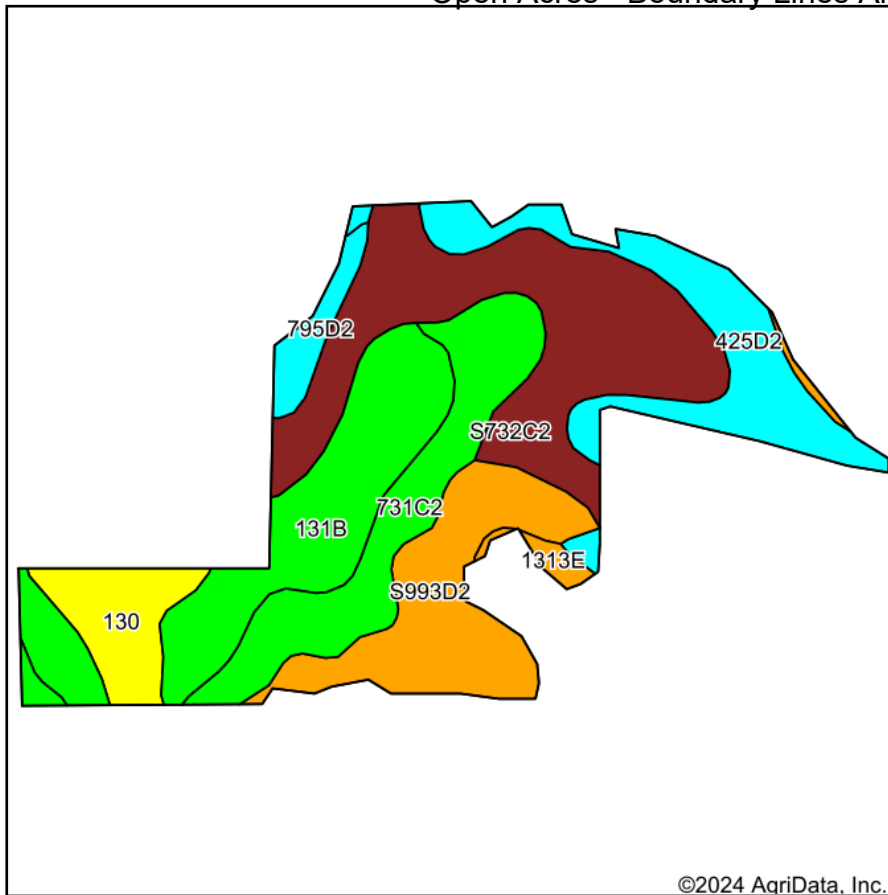

State: **Iowa**  
 County: **Wapello**  
 Location: **13-72N-15W**  
 Township: **Polk**  
 Acres: **31.99**  
 Date: **12/26/2024**

**Hawkeye Farm Mgmt & Real Estate**

22 N Main, Albia IA Phone: 561-952-7796  
 Cell: 561-952-7796  
 Email: hawkeyefarm@hawkeyefarm.com  
 www.hawkeyefarm.com

Maps Provided By:

**surety**  
 CUSTOMIZED ONLINE MAPPING  
 © AgriData, Inc. 2023 www.AgriDataInc.com



Area Symbol: IA179, Soil Area Version: 33

Code	Soil Description	Acres	Percent of field	CSR2 Legend	Non-Irr Class *c	CSR2**	CSR	*n NCCPI Corn	*n NCCPI Soybeans
S732C2	Weller silty clay loam, 5 to 9 percent slopes, moderately eroded	8.45	26.4%		IIIe	59		81	67
131B	Pershing silt loam, 2 to 5 percent slopes	6.20	19.4%		IIIe	70	65	74	59
731C2	Pershing silty clay loam, 5 to 9 percent slopes, moderately eroded	4.79	15.0%		IIIe	62	40	68	56
S993D2	Gara-Armstrong loams, 9 to 14 percent slopes, moderately eroded	4.71	14.7%		IVe	35		66	48
425D2	Keswick loam, 9 to 14 percent slopes, moderately eroded	4.47	14.0%		IVe	9	5	56	41
130	Belinda silt loam, 0 to 2 percent slopes	2.05	6.4%		IIIw	47	60	75	63
795D2	Ashgrove silty clay loam, 9 to 14 percent slopes, moderately eroded	0.87	2.7%		IVe	7	7	50	39
1313E	Munterville silt loam, 9 to 18 percent slopes	0.45	1.4%		VIIe	30	10	55	43
Weighted Average					3.37	48.5	*-	*n 70.4	*n 56

\*\*IA has updated the CSR values for each county to CSR2.

\*- CSR weighted average cannot be calculated on the current soils data, use prior data version for csr values.

\*n: The aggregation method is "Weighted Average using all components"

\*c: Using Capabilities Class Dominant Condition Aggregation Method