

# Soils Map

Boundary Lines Are Approximate

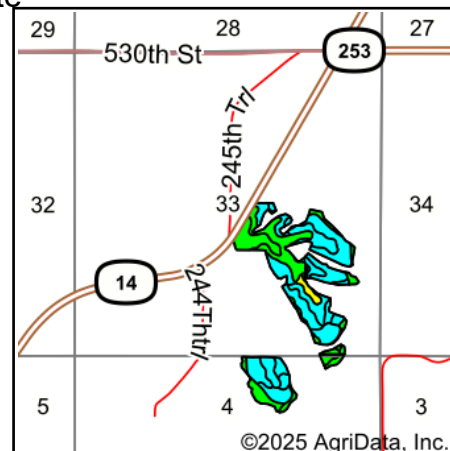
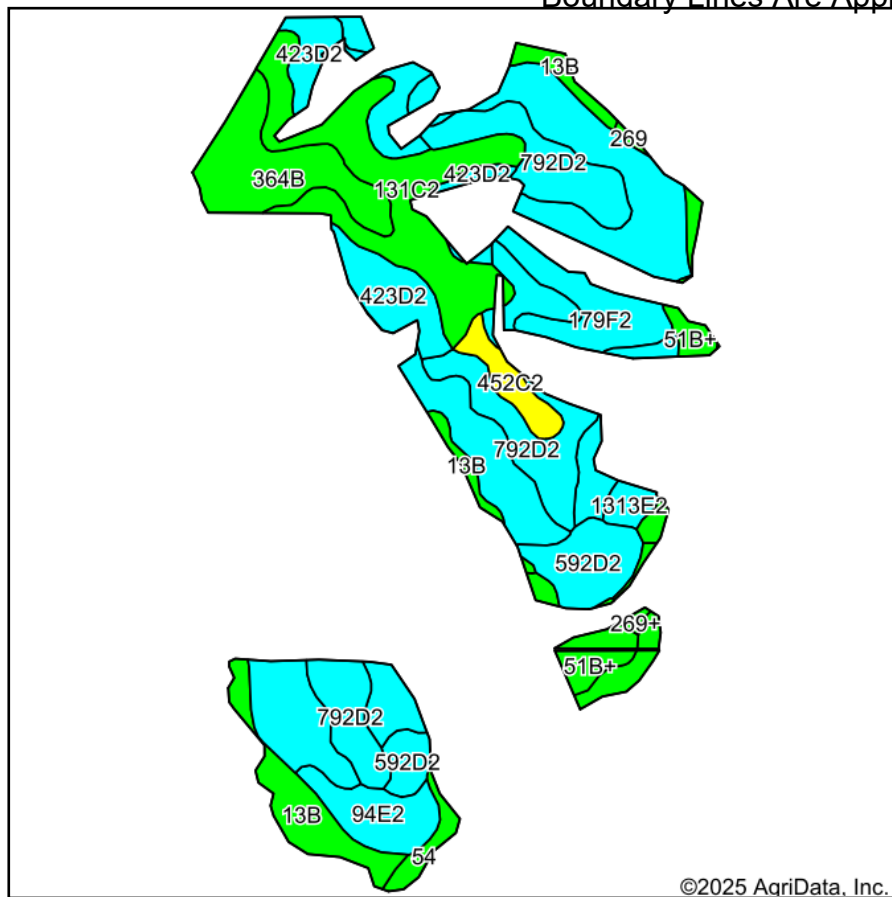

State: **Iowa**  
 County: **Lucas**  
 Location: **33-73N-21W**  
 Township: **English**  
 Acres: **66.95**  
 Date: **9/5/2025**

**Hawkeye Farm Mgmt & Real Estate**

**United Country Real Estate**  
 22 N Main, Albion IA Phone: 641-932-7796  
 Email: hawkeye@uciowa.com  
 On the web: www.uciowa.com; www.iowawhitehillfarms.com

Maps Provided By:  
**surety**  
 CUSTOMIZED ONLINE MAPPING  
 © AgriData, Inc. 2023 www.AgriDataInc.com



Area Symbol: IA117, Soil Area Version: 33

Code	Soil Description	Acres	Percent of field	CSR2 Legend	Non-Irr Class *c	CSR2**	CSR	*n NCCPI Corn	*n NCCPI Soybeans
179F2	Gara clay loam, 18 to 25 percent slopes, moderately eroded	15.67	23.5%		IVe	11	13	52	34
792D2	Armstrong clay loam, 9 to 14 percent slopes, moderately eroded	10.64	15.9%		IVe	5	13	58	42
131C2	Pershing silty clay loam, 5 to 9 percent slopes, moderately eroded	8.65	12.9%		IIIe	62	45	68	56
423D2	Bucknell silty clay loam, 9 to 14 percent slopes, moderately eroded	5.44	8.1%		IVe	6	13	62	48
364B	Grundy silty clay loam, 2 to 5 percent slopes	5.03	7.5%		Ile	72	75	79	68
13B	Zook-Olmitz-Vesser complex, 0 to 5 percent slopes	4.18	6.2%		IIw	68	53	70	74
592D2	Mystic clay loam, 9 to 14 percent slopes, moderately eroded	3.76	5.6%		IVe	10	5	67	50
179E2	Gara clay loam, 14 to 18 percent slopes, moderately eroded	3.54	5.3%		Vle	23	33	62	42
94E2	Mystic-caleb complex, 14 to 18 percent slopes, moderately eroded	2.58	3.9%		Vle	17	12	65	48
51B+	Vesser silt loam, 2 to 5 percent slopes, overwash	2.43	3.6%		IIw	69	65	70	80
54	Zook silty clay loam, heavy till, 0 to 2 percent slopes, occasionally flooded	2.09	3.1%		IIw	68	75	74	67
452C2	Lineville silt loam, 5 to 9 percent slopes, moderately eroded	1.46	2.2%		IIIe	46	31	71	52
1313E2	Munterville silty clay loam, 14 to 18 percent slopes, moderately eroded	1.09	1.6%		Vle	22	5	56	38

Soils data provided by USDA and NRCS.

Code	Soil Description	Acres	Percent of field	CSR2 Legend	Non-Irr Class *c	CSR2**	CSR	*n NCCPI Corn	*n NCCPI Soybeans
269+	Humeston silt loam, 0 to 2 percent slopes, overwash, occasionally flooded	0.27	0.4%		IIIw	72	63	82	69
269	Humeston silty clay loam, 0 to 2 percent slopes, occasionally flooded	0.12	0.2%		IIIw	70	58	90	81
Weighted Average					3.65	30.4	29.2	*n 62.9	*n 49.5

\*\*IA has updated the CSR values for each county to CSR2.

\*n: The aggregation method is "Weighted Average using all components"

\*c: Using Capabilities Class Dominant Condition Aggregation Method