

Soils Map

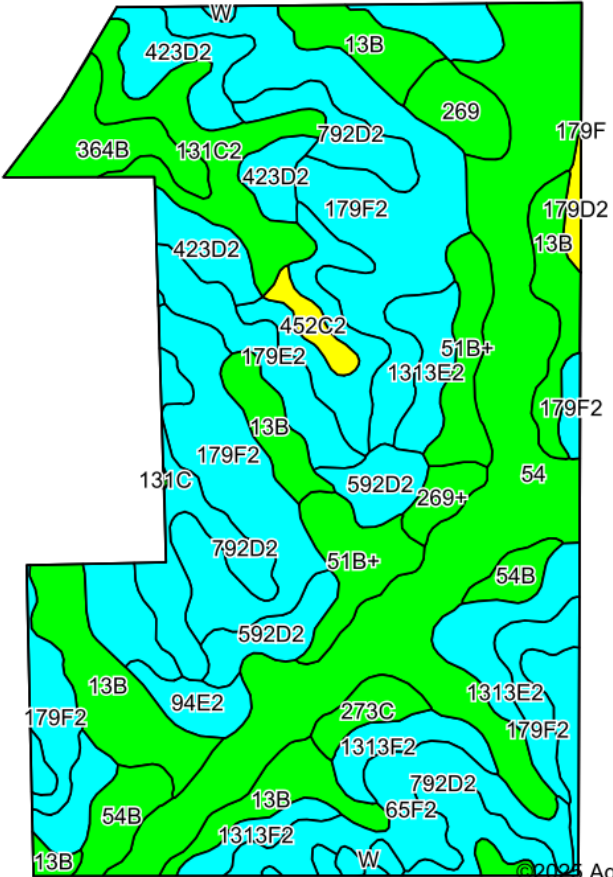

©2025 AgriData, Inc.

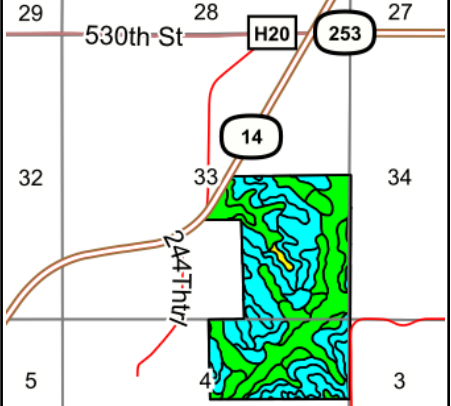

State: **Iowa**
County: **Lucas**
Location: **33-73N-21W**
Township: **English**
Acres: **218**
Date: **9/5/2025**



22 N Main, Albion IA Phone: 641-932-7796
Email: hawkeye@uciowa.com
On the web: www.uciowa.com;
www.iowawhitetailfarms.com

Maps Provided By:



Area Symbol: IA117, Soil Area Version: 33

Code	Soil Description	Acres	Percent of field	CSR2 Legend	Non-Irr Class *c	CSR2**	CSR	*n NCCPI Corn	*n NCCPI Soybeans
179F2	Gara clay loam, 18 to 25 percent slopes, moderately eroded	45.08	20.7%		IVe	11	13	52	34
54	Zook silty clay loam, heavy till, 0 to 2 percent slopes, occasionally flooded	39.72	18.2%		IIw	68	75	74	67
13B	Zook-Olmitz-Vesser complex, 0 to 5 percent slopes	23.57	10.8%		IIw	68	53	70	74
792D2	Armstrong clay loam, 9 to 14 percent slopes, moderately eroded	22.45	10.3%		IVe	5	13	58	42
131C2	Pershing silty clay loam, 5 to 9 percent slopes, moderately eroded	9.76	4.5%		IIIe	62	45	68	56
423D2	Bucknell silty clay loam, 9 to 14 percent slopes, moderately eroded	9.29	4.3%		IVe	6	13	62	48
51B+	Vesser silt loam, 2 to 5 percent slopes, overwash	9.17	4.2%		IIw	69	65	70	80
65F2	Lindley loam, 18 to 25 percent slopes, moderately eroded	8.60	3.9%		VIIe	10	8	51	37
1313E2	Munterville silty clay loam, 14 to 18 percent slopes, moderately eroded	7.99	3.7%		VIe	22	5	56	38
592D2	Mystic clay loam, 9 to 14 percent slopes, moderately eroded	5.97	2.7%		IVe	10	5	67	50
364B	Grundy silty clay loam, 2 to 5 percent slopes	5.58	2.6%		Ile	72	75	79	68
179E2	Gara clay loam, 14 to 18 percent slopes, moderately eroded	5.46	2.5%		VIe	23	33	62	42
1313F2	Munterville silty clay loam, 18 to 25 percent slopes, moderately eroded	5.01	2.3%		VIe	5	5	45	28

Soils data provided by USDA and NRCS.

Code	Soil Description	Acres	Percent of field	CSR2 Legend	Non-Irr Class *c	CSR2**	CSR	*n NCCPI Corn	*n NCCPI Soybeans
94E2	Mystic-caleb complex, 14 to 18 percent slopes, moderately eroded	4.85	2.2%		Vle	17	12	65	48
54B	Zook silty clay loam, heavy till, 2 to 5 percent slopes, rarely flooded	4.72	2.2%		IIw	71	65	64	69
269	Humeston silty clay loam, 0 to 2 percent slopes, occasionally flooded	3.36	1.5%		IIIw	70	58	90	81
273C	Olmitz loam, heavy till, 5 to 9 percent slopes	2.21	1.0%		IIle	77	57	85	71
269+	Humeston silt loam, 0 to 2 percent slopes, overwash, occasionally flooded	1.88	0.9%		IIIw	72	63	82	69
452C2	Lineville silt loam, 5 to 9 percent slopes, moderately eroded	1.52	0.7%		IIle	46	31	71	52
W	Water	0.97	0.4%			0	0		
179D2	Gara clay loam, 9 to 14 percent slopes, moderately eroded	0.84	0.4%		IVe	45	43	72	54
Weighted Average					*-	37.4	36.3	*n 63.5	*n 52.8

**IA has updated the CSR values for each county to CSR2.

*n: The aggregation method is "Weighted Average using all components"

*c: Using Capabilities Class Dominant Condition Aggregation Method

*- Non Irr Class weighted average cannot be calculated on the current soils data due to missing data.