

# Soils Map

Boundary Lines Are Approximate

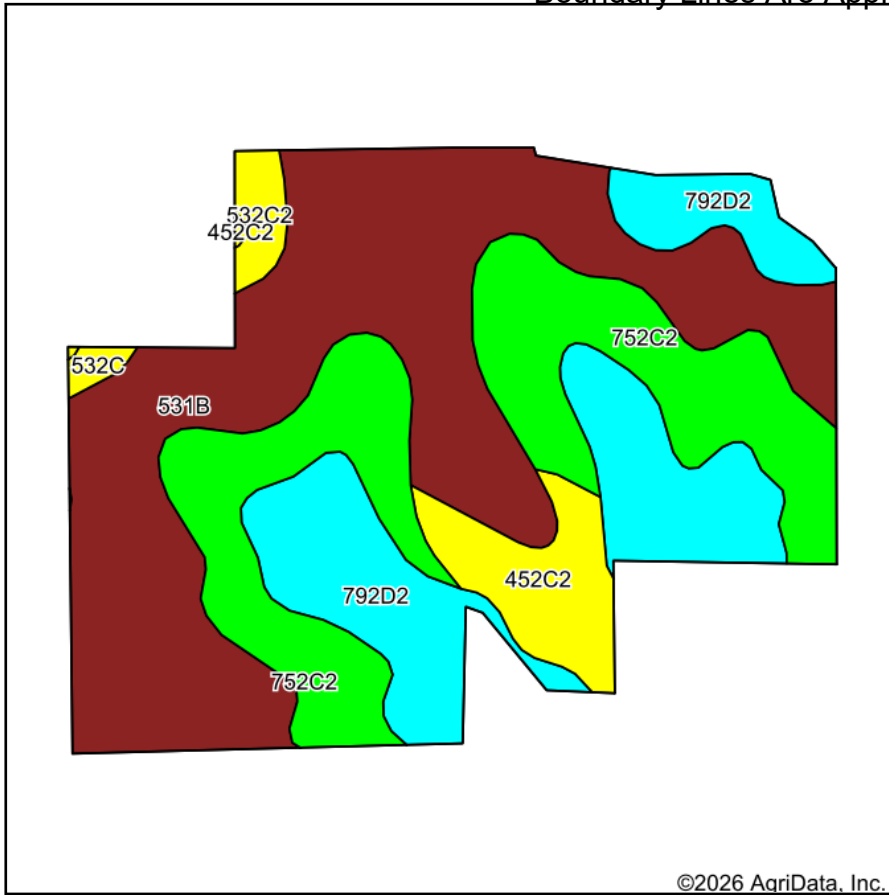

Soils data provided by USDA and NRCS.

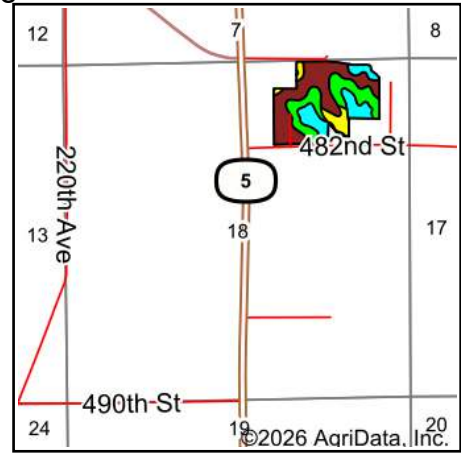

State: **Iowa**  
 County: **Appanoose**  
 Location: **18-69N-17W**  
 Township: **Vermillion**  
 Acres: **38.56**  
 Date: **2/6/2026**



**Hawkeye  
Real Estate**

Maps Provided By:



Area Symbol: IA007, Soil Area Version: 32

Code	Soil Description	Acres	Percent of field	CSR2 Legend	Non-Irr Class *c	CSR2**	CSR	*n NCCPI Corn	*n NCCPI Soybeans	
531B	Kniffin silt loam, 2 to 5 percent slopes	16.81	43.5%		IIle	55	58	64	66	
752C2	Lineville silt loam, dark variant, 5 to 9 percent slopes, moderately eroded	10.32	26.8%		IIle	68	35	79	56	
792D2	Armstrong loam, 9 to 14 percent slopes, moderately eroded	8.15	21.1%		IVe	9	11	62	43	
452C2	Lineville silt loam, 5 to 9 percent slopes, moderately eroded	2.42	6.3%		IIle	46	30	71	52	
532C2	Rathbun silty clay loam, 5 to 9 percent slopes, moderately eroded	0.64	1.7%		IIle	44	28	72	51	
532C	Rathbun silt loam, 5 to 9 percent slopes	0.22	0.6%		IIle	47	32	76	58	
<b>Weighted Average</b>						<b>3.21</b>	<b>48</b>	<b>39.5</b>	<b>*n 68.2</b>	<b>*n 57.3</b>

\*\*IA has updated the CSR values for each county to CSR2.

\*n: The aggregation method is "Weighted Average using all components"

\*c: Using Capabilities Class Dominant Condition Aggregation Method

Soils data provided by USDA and NRCS.