

# Soils Map

Boundary Lines Are Approximate

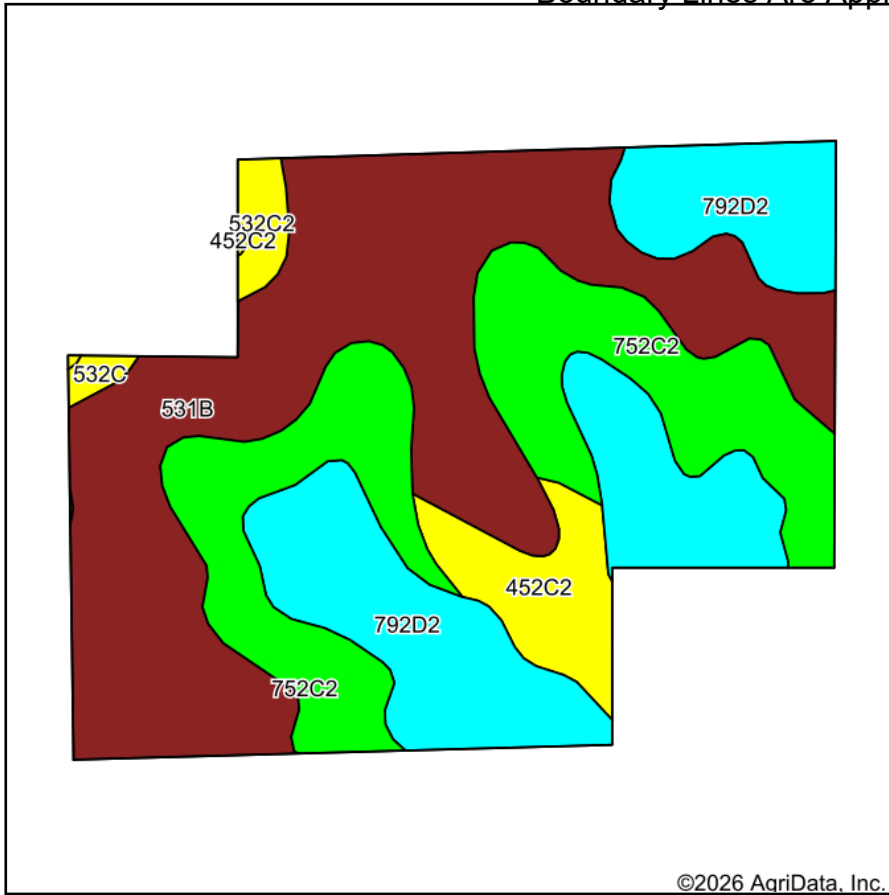

Soils data provided by USDA and NRCS.

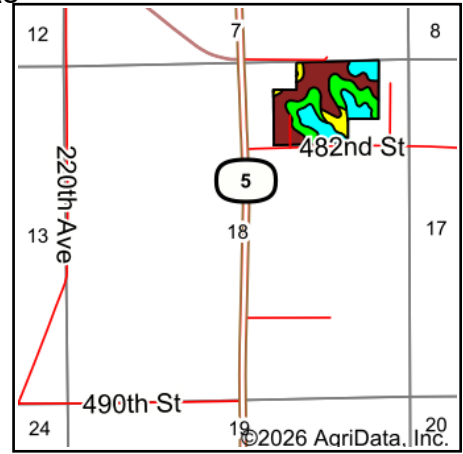

State: **Iowa**  
 County: **Appanoose**  
 Location: **18-69N-17W**  
 Township: **Vermillion**  
 Acres: **41**  
 Date: **2/6/2026**



**Hawkeye  
Real Estate**

Maps Provided By:



© AgriData, Inc. 2025

www.AgriDataInc.com



Area Symbol: IA007, Soil Area Version: 32

Code	Soil Description	Acres	Percent of field	CSR2 Legend	Non-Irr Class *c	CSR2**	CSR	*n NCCPI Corn	*n NCCPI Soybeans	
531B	Kniffen silt loam, 2 to 5 percent slopes	17.00	41.4%		IIle	55	58	64	66	
792D2	Armstrong loam, 9 to 14 percent slopes, moderately eroded	10.52	25.7%		IVe	9	11	62	43	
752C2	Lineville silt loam, dark variant, 5 to 9 percent slopes, moderately eroded	10.22	24.9%		IIle	68	35	79	56	
452C2	Lineville silt loam, 5 to 9 percent slopes, moderately eroded	2.40	5.9%		IIle	46	30	71	52	
532C2	Rathbun silty clay loam, 5 to 9 percent slopes, moderately eroded	0.63	1.5%		IIle	44	28	72	51	
532C	Rathbun silt loam, 5 to 9 percent slopes	0.23	0.6%		IIle	47	32	76	58	
<b>Weighted Average</b>						<b>3.26</b>	<b>45.7</b>	<b>38</b>	<b>*n 67.8</b>	<b>*n 56.5</b>

\*\*IA has updated the CSR values for each county to CSR2.

\*n: The aggregation method is "Weighted Average using all components"

\*c: Using Capabilities Class Dominant Condition Aggregation Method

Soils data provided by USDA and NRCS.