

Soils Map

*Boundary Lines are Approximate

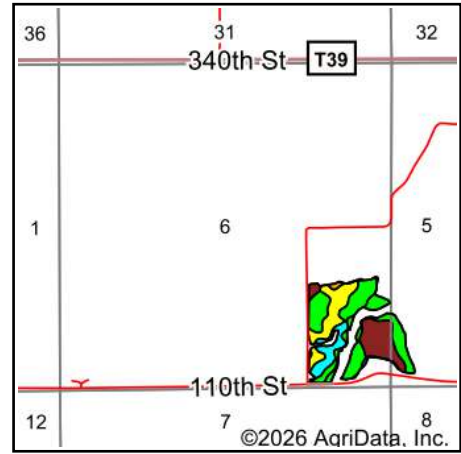

State: **Iowa**
 County: **Monroe**
 Location: **6-73N-16W**
 Township: **Pleasant**
 Acres: **39.02**
 Date: **2/20/2026**

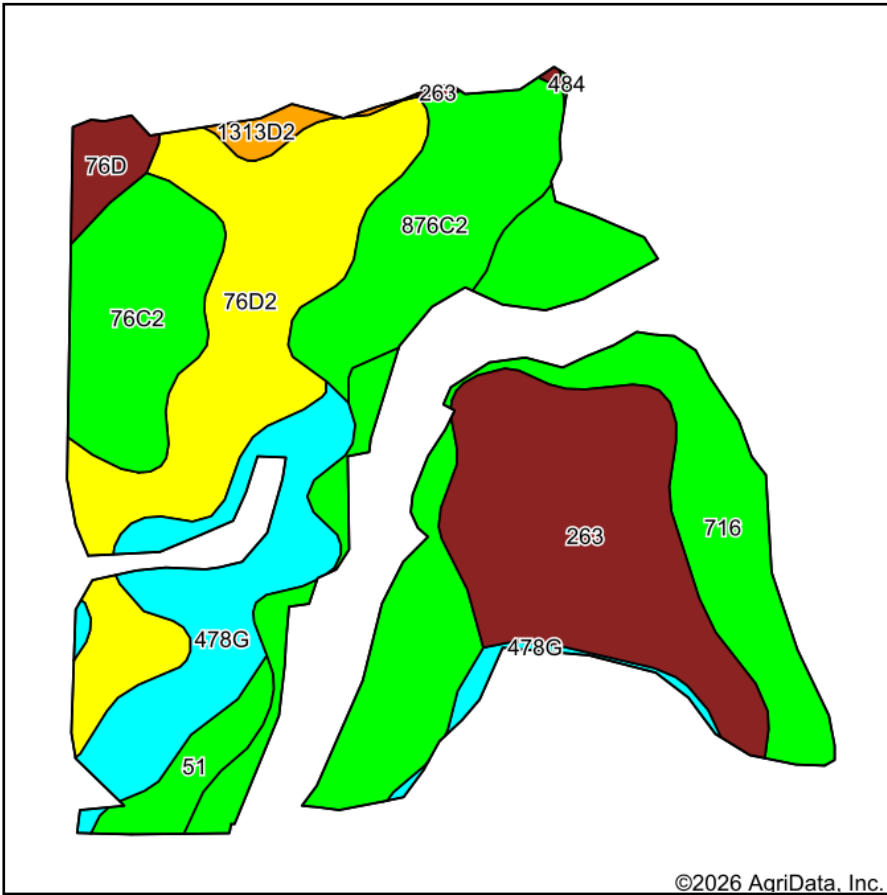

Hawkeye Real Estate

Maps Provided By:



Soils data provided by USDA and NRCS.

©2026 AgriData, Inc.

© AgriData, Inc. 2025

www.AgriDataInc.com

Area Symbol: IA135, Soil Area Version: 33

Code	Soil Description	Acres	Percent of field	CSR2 Legend	Non-Irr Class *c	CSR2**	CSR	*n NCCPI Corn	*n NCCPI Soybeans
716	Lawson-Quiver-Nodaway complex, 0 to 2 percent slopes, occasionally flooded	9.49	24.4%		Ilw	78		79	86
76D2	Ladoga silt loam, 9 to 14 percent slopes, eroded	7.55	19.3%		Ille	49	55	81	62
263	Okaw silt loam, heavy till, 0 to 2 percent slopes, rarely flooded	7.39	18.9%		Illw	52	53	69	60
478G	Munterville-Rock outcrop complex, 14 to 40 percent slopes	4.64	11.9%		Vlle	5	5	13	6
876C2	Ladoga silt loam, terrace, 5 to 9 percent slopes, eroded	4.16	10.7%		Ille	77	65	84	67
76C2	Ladoga silt loam, 5 to 9 percent slopes, eroded	3.63	9.3%		Ille	75	65	85	67
51	Vesser silt loam, 0 to 2 percent slopes	1.06	2.7%		Ilw	74	70	75	86
76D	Ladoga silt loam, 9 to 14 percent slopes	0.72	1.8%		Ille	55	60	88	72
1313D2	Munterville silt loam, 9 to 14 percent slopes, moderately eroded	0.38	1.0%		Vle	34	10	59	42
Weighted Average						3.23	57.4	*n 70.6	*n 62.4

**IA has updated the CSR values for each county to CSR2.

*- CSR weighted average cannot be calculated on the current soils data, use prior data version for csr values.

*n: The aggregation method is "Weighted Average using all components"

*c: Using Capabilities Class Dominant Condition Aggregation Method

Soils data provided by USDA and NRCS.