

Soils Map

Boundary Lines are Approximate

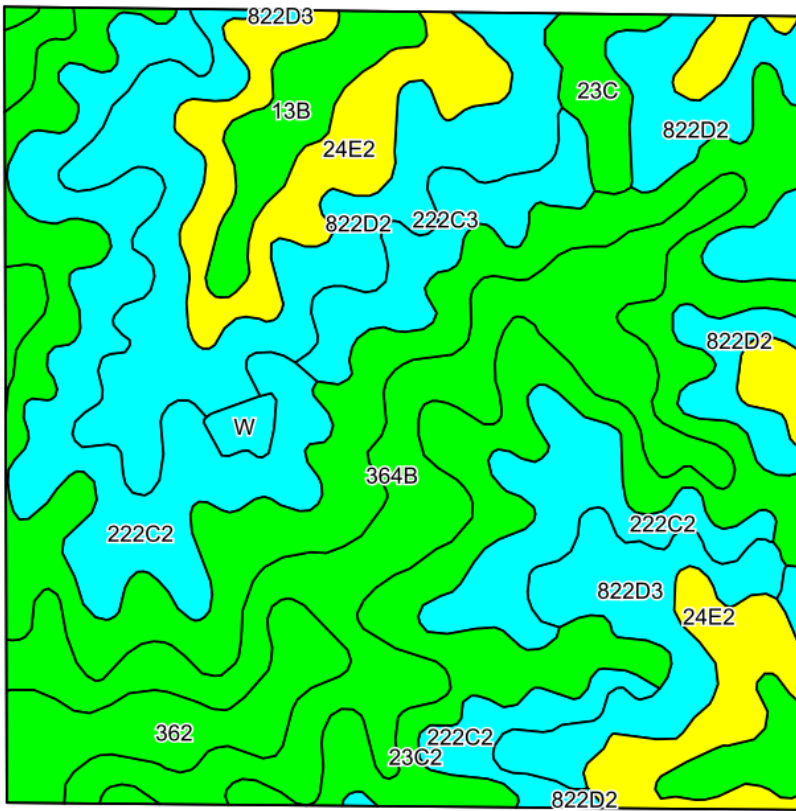

©2026 AgriData, Inc.

Soils data provided by USDA and NRCS.

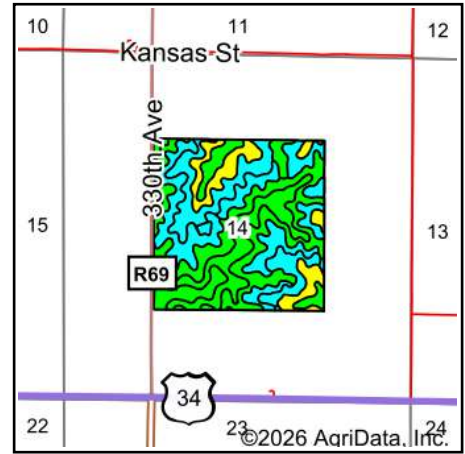

State: **Iowa**
 County: **Clarke**
 Location: **14-72N-24W**
 Township: **Jackson**
 Acres: **158**
 Date: **2/20/2026**



Hawkeye Real Estate

Maps Provided By:



© AgriData, Inc. 2025

www.AgriDataInc.com



Area Symbol: IA039, Soil Area Version: 31

Code	Soil Description	Acres	Percent of field	CSR2 Legend	Non-Irr Class *c	CSR2**	CSR	*n NCCPI Corn	*n NCCPI Soybeans	
23C2	Arispe silty clay loam, 5 to 9 percent slopes, moderately eroded	38.34	24.2%			IIIe	62	50	73	
822D2	Lamoni clay loam, 9 to 14 percent slopes, moderately eroded	25.65	16.2%			IVe	11	15	63	
222C2	Clarinda silty clay loam, 5 to 9 percent slopes, moderately eroded	25.13	15.9%			IVw	28	25	54	
364B	Grundy silty clay loam, 2 to 5 percent slopes	23.08	14.6%			Ile	72	75	79	
24E2	Shelby clay loam, 14 to 18 percent slopes, moderately eroded	16.68	10.6%			IVe	40	33	66	
822D3	Lamoni clay loam, 9 to 14 percent slopes, severely eroded	7.44	4.7%			VIe	7	5	56	
13B	Olmitz-Zook-Colo complex, 0 to 5 percent slopes	6.75	4.3%			IIw	77	60	76	
362	Haig silt loam, 0 to 2 percent slopes	6.33	4.0%			IIw	83	70	74	
222C3	Clarinda silty clay, 5 to 9 percent slopes, severely eroded	5.16	3.3%			VIe	21	15	40	
23C	Arispe silty clay loam, 5 to 9 percent slopes	2.63	1.7%			IIIe	66	55	78	
W	Water	0.81	0.5%				0	0		
Weighted Average						*-	44.8	40	*n 66.5	*n 54.8

**IA has updated the CSR values for each county to CSR2.

*n: The aggregation method is "Weighted Average using all components"

*c: Using Capabilities Class Dominant Condition Aggregation Method

*- Non Irr Class weighted average cannot be calculated on the current soils data due to missing data.

Soils data provided by USDA and NRCS.