

Soils Map

*Boundary Lines are Approximate

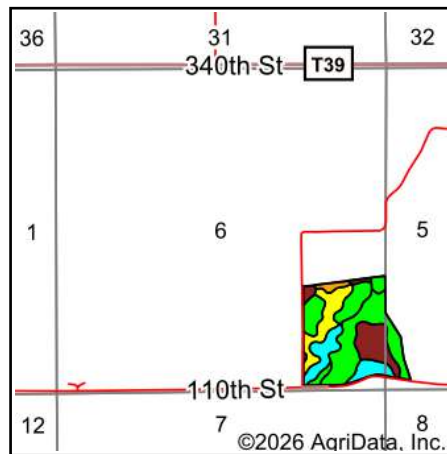

State: **Iowa**
 County: **Monroe**
 Location: **6-73N-16W**
 Township: **Pleasant**
 Acres: **53**
 Date: **2/20/2026**

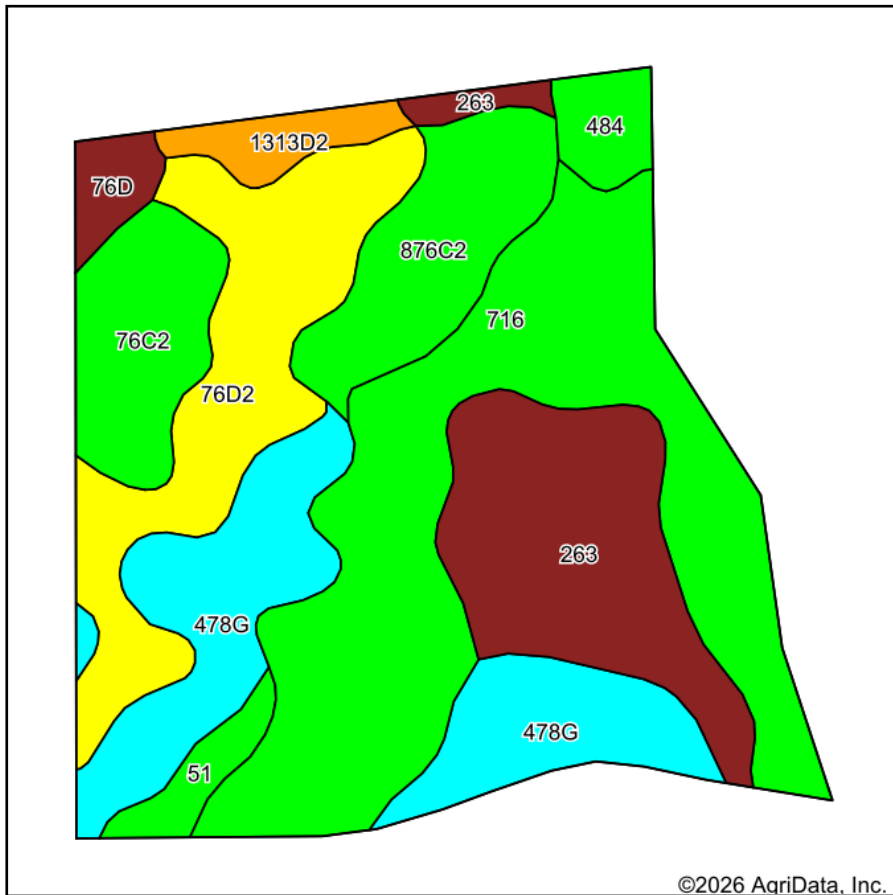

**Hawkeye
Real Estate**

Maps Provided By:



© AgriData, Inc. 2025

www.AgriDataInc.com



Soils data provided by USDA and NRCS.

Area Symbol: IA135, Soil Area Version: 33

Code	Soil Description	Acres	Percent of field	CSR2 Legend	Non-Irr Class *c	CSR2**	CSR	*n NCCPI Corn	*n NCCPI Soybeans	
716	Lawson-Quiver-Nodaway complex, 0 to 2 percent slopes, occasionally flooded	16.19	30.5%		Ilw	78		79	86	
478G	Munterville-Rock outcrop complex, 14 to 40 percent slopes	8.63	16.3%		Vlle	5	5	13	6	
263	Okaw silt loam, heavy till, 0 to 2 percent slopes, rarely flooded	7.88	14.9%		Illw	52	53	69	60	
76D2	Ladoga silt loam, 9 to 14 percent slopes, eroded	7.85	14.8%		Ille	49	55	81	62	
876C2	Ladoga silt loam, terrace, 5 to 9 percent slopes, eroded	4.39	8.3%		Ille	77	65	84	67	
76C2	Ladoga silt loam, 5 to 9 percent slopes, eroded	3.67	6.9%		Ille	75	65	85	67	
1313D2	Munterville silt loam, 9 to 14 percent slopes, moderately eroded	1.24	2.3%		Vlle	34	10	59	42	
484	Lawson silt loam, 0 to 2 percent slopes	1.18	2.2%		Ilw	87	90	84	93	
51	Vesser silt loam, 0 to 2 percent slopes	1.04	2.0%		Ilw	74	70	75	86	
76D	Ladoga silt loam, 9 to 14 percent slopes	0.93	1.8%		Ille	55	60	88	72	
Weighted Average						3.37	56.4	*	*n 67.6	*n 61.5

**IA has updated the CSR values for each county to CSR2.

*- CSR weighted average cannot be calculated on the current soils data, use prior data version for csr values.

*n: The aggregation method is "Weighted Average using all components"

*c: Using Capabilities Class Dominant Condition Aggregation Method