

Soils Map

Boundary Lines Are Approximate

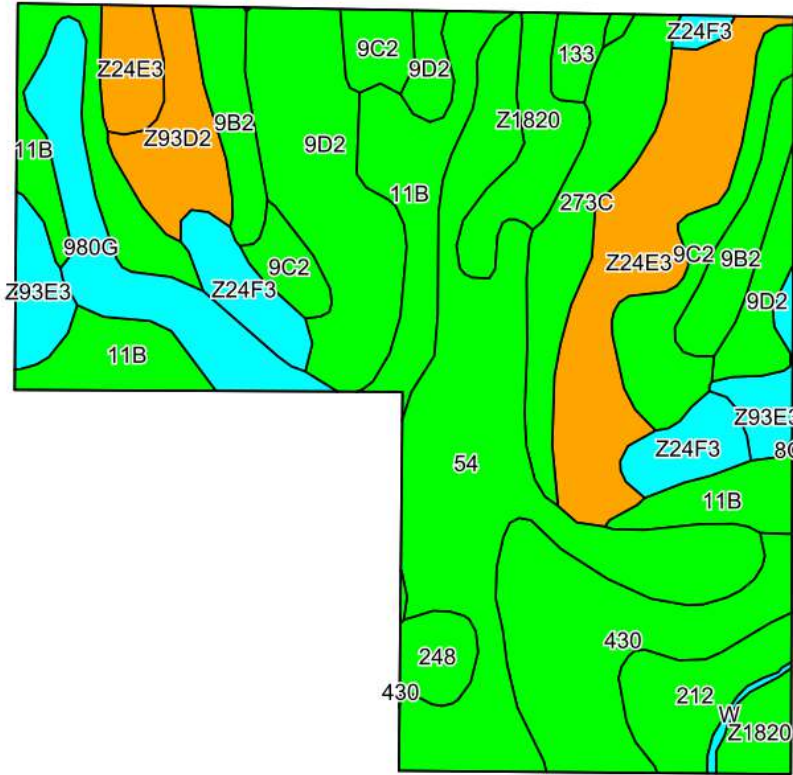

©2026 AgriData, Inc.

Soils data provided by USDA and NRCS.

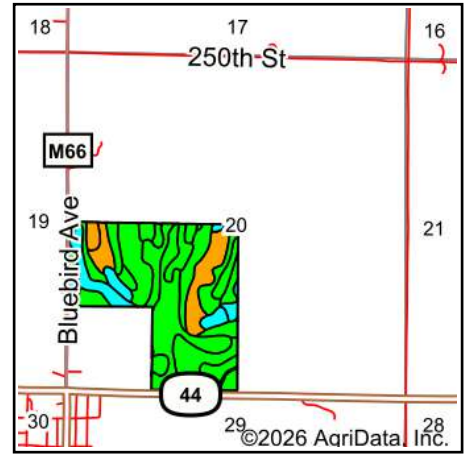

State: **Iowa**
 County: **Audubon**
 Location: **20-79N-36W**
 Township: **Sharon**
 Acres: **120**
 Date: **5/11/2026**



Hawkeye Real Estate

Maps Provided By:



© AgriData, Inc. 2025

www.AgriDataInc.com



Area Symbol: IA009, Soil Area Version: 31

Code	Soil Description	Acres	Percent of field	CSR2 Legend	Non-Irr Class *c	CSR2**	CSR	*n NCCPI Corn	*n NCCPI Soybeans	
54	Zook silty clay loam, 0 to 2 percent slopes, occasionally flooded	19.99	16.7%			Ilw	67	70	58	63
11B	Judson-Colo-Ackmore complex, 2 to 5 percent slopes	15.25	12.7%			Ilw	81	68	86	81
Z24E3	Shelby clay loam, deep loess, 14 to 18 percent slopes, severely eroded	12.85	10.7%			Vle	32		62	42
9D2	Marshall silty clay loam, 9 to 14 percent slopes, eroded	12.83	10.7%			Ille	61	58	85	65
430	Ackmore silt loam, 0 to 2 percent slopes, occasionally flooded	9.71	8.1%			Ilw	77	83	90	86
9C2	Marshall silty clay loam, 5 to 9 percent slopes, eroded	7.38	6.2%			Ille	87	68	90	70
273C	Olmitz loam, 5 to 9 percent slopes	6.30	5.2%			Ille	85	57	96	81
980G	Gullied land-Judson complex, 5 to 40 percent slopes	6.27	5.2%			Vlle	5	5	10	9
9B2	Marshall silty clay loam, 2 to 5 percent slopes, eroded	5.30	4.4%			lle	92	83	91	71
Z1820	Dockery-Quiver silt loams, deep loess, 0 to 2 percent slopes, occasionally flooded	5.19	4.3%			Ilw	87		84	92
Z24F3	Shelby clay loam, deep loess, 18 to 25 percent slopes, severely eroded	4.85	4.0%			Vle	14		52	31
Z93D2	Shelby-Adair clay loams, deep loess, 9 to 14 percent slopes, eroded	3.93	3.3%			Ille	38		67	50
212	Kennebec silt loam, 0 to 2 percent slopes, occasionally flooded	3.73	3.1%			lw	91	91	95	93
Z93E3	Shelby-Adair clay loams, deep loess, 14 to 18 percent slopes, severely eroded	3.45	2.9%			Vlle	22		59	35

Soils data provided by USDA and NRCS.



Code	Soil Description	Acres	Percent of field	CSR2 Legend	Non-Irr Class *c	CSR2**	CSR	*n NCCPI Corn	*n NCCPI Soybeans	
248	Wabash silty clay loam, 0 to 1 percent slopes	1.66	1.4%		IIIw	61	60	55	62	
133	Colo silty clay loam, deep loess, 0 to 2 percent slopes, occasionally flooded	1.05	0.9%		IIw	78	80	75	80	
W	Water	0.26	0.2%			0	0			
Weighted Average						*-	62.3	*-	*n 72.7	*n 63.7

**IA has updated the CSR values for each county to CSR2.

*- CSR weighted average cannot be calculated on the current soils data, use prior data version for csr values.

*n: The aggregation method is "Weighted Average using all components"

*c: Using Capabilities Class Dominant Condition Aggregation Method

*- Non Irr Class weighted average cannot be calculated on the current soils data due to missing data.